











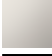

## Pomme de douche arrosoir à fixation murale 300 mm - Bronze brossé

SERIES SPECIFIC

28 679 970 Version du produit de 13/03/2017



- saillie 450 mm
- Ø de pomme de douche arrosoir 300 mm
- PURE RAIN, débit max. 14 l/min (à 3 bar)
- Fonction à partir de: 10 l/min
- rosace Ø 60 mm
- raccord 1/2"
- avec système anti-calcaire
- avec fonction anti-gouttes

	Bronze brossé	28 679 970-42
	Chrome	28 679 970-00
	Platine brossé	28 679 970-06
	Platine	28 679 970-08
	Dark Chrome	28 679 970-19
	Or clair	28 679 970-26
	Or clair brossé	28 679 970-27
	Laiton brossé (Or 23cts)	28 679 970-28
	Noir mat	28 679 970-33
	Champagne brossé (Or 22cts)	28 679 970-46
	Champagne (Or 22cts)	28 679 970-47
	Chrome brossé	28 679 970-93
	Dark Platinum brossé	28 679 970-99

### Accessoires recommandés



- Coude mural à encastrer -** 35 085 970 90
- profondeur de montage mini. 90 mm
  - profondeur de montage max. 163 mm

mm [inches]

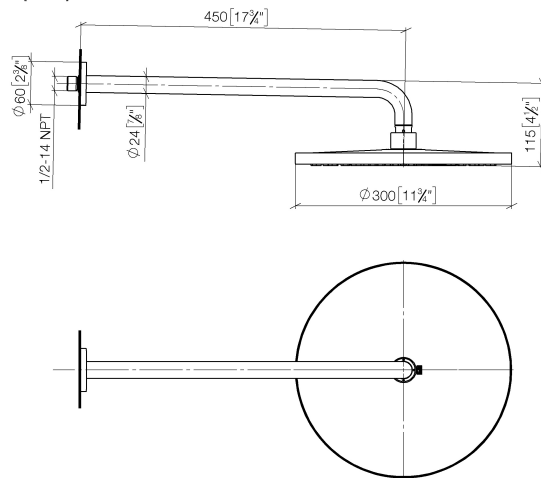

### Diagramme de débit

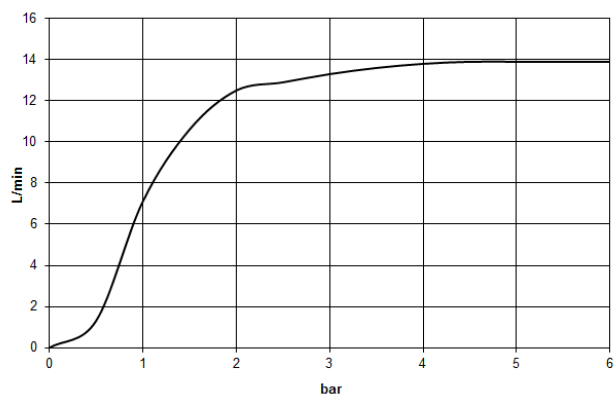

### Codes & Standards

DIN 4109

EN 1112

ISO 3822

Scottish Water  
Byelaws

UK Water Supply  
Regulations

Ü-Zeichen



Pomme de douche arrosoir à fixation murale 300 mm - Bronze brossé

SERIES SPECIFIC

28 679 970 Version du produit de 13/03/2017

Certificats et durabilité

WRAS_2212	DVGW_DW- 6517DN0	LGA_29
-----------	---------------------	--------

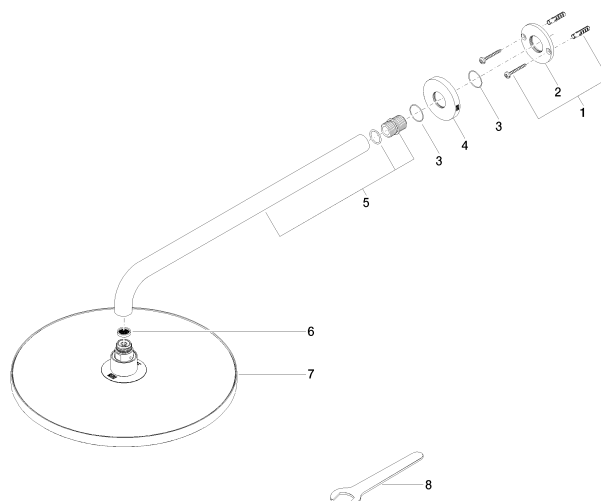

## Liste des pièces de rechange

N°	Article Numéro	Désignation	Fréquence de montage	Délai de livraison
2	09 17 20 120 90	patte de fixation	1,00	2
5	90 11 03 070 00-42	tuyau	1,00	30
8	90 30 09 069 00 90	clé à écrou	1,00	2
3	09 14 10 150 90	joint	2,00	2
7	04 12 05 091 00-42	douche	1,00	60
6	09 23 01 075 90	élément insérable	1,00	2
1	04 30 31 032 00 90	set de fixation	1,00	2
4	09 27 97 015-42	rosace	1,00	30