

VAIA Two-hole bridge mixer for rinsing/Profi spray - Brushed Platinum

VAIA



19 825 809

Product version from 7/1/2023



- 241mm projection
  - pivotable spout 360°
  - air-enriched flow
  - max. flow 5.7 l/min at 3 bar flow pressure
  - lead-free
  - This product can help a building meet the requirements of Green Building Rating Systems, e.g. LEED®, BREEAM®, DGNB

Two-hole mixer for combining with rinsing/Profi spray only

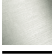
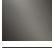
	Brushed Platinum	19 825 809-06 0010
	Chrome	19 825 809-00 0010
	Platinum	19 825 809-08 0010
	Durabrass (23kt Gold)	19 825 809-09 0010
	Dark Chrome	19 825 809-19 0010
	Brushed Durabrass (23kt Gold)	19 825 809-28 0010
	Matte Black	19 825 809-33 0010
	Brushed Bronze	19 825 809-42 0010
	Brushed Champagne (22kt Gold)	19 825 809-46 0010
	Champagne (22kt Gold)	19 825 809-47 0010
	Brushed Chrome	19 825 809-93 0010
	Brushed Dark Platinum	19 825 809-99 0010

Recommended miscellaneous

VAIA Dispenser with rosette -  
Brushed Platinum

82 434 809-06



Recommended miscellaneous

VAIA AIR SWITCH Control button -

10 713 809-06

Brushed Platinum



## VAIA Two-hole bridge mixer for rinsing/Profi spray - Brushed Platinum

VAIA

19 825 809 Product version from 7/1/2023

mm [inches]

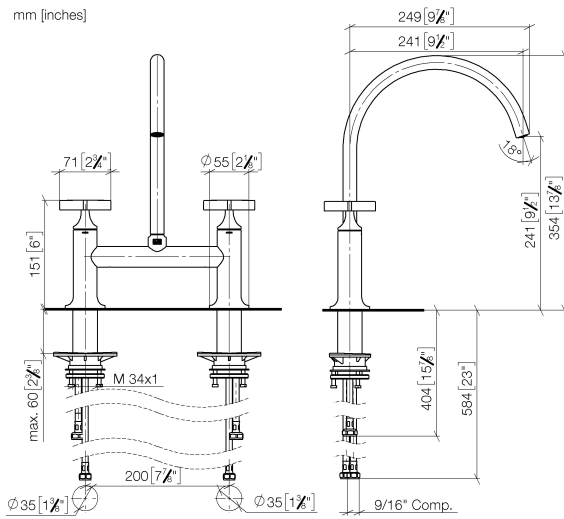

### Codes & Standards

ASME A112.18.1	California Energy Commission (CEC)	cUPC	NSF372
NSF61			

### Certificates and sustainability

IAPMO_4976	IAPMO_N-4976	IAPMO_6397
------------	--------------	------------

19 825 809 Product version from 7/1/2023

Parts for other  
finishes can be found  
here: [Chrome](#)

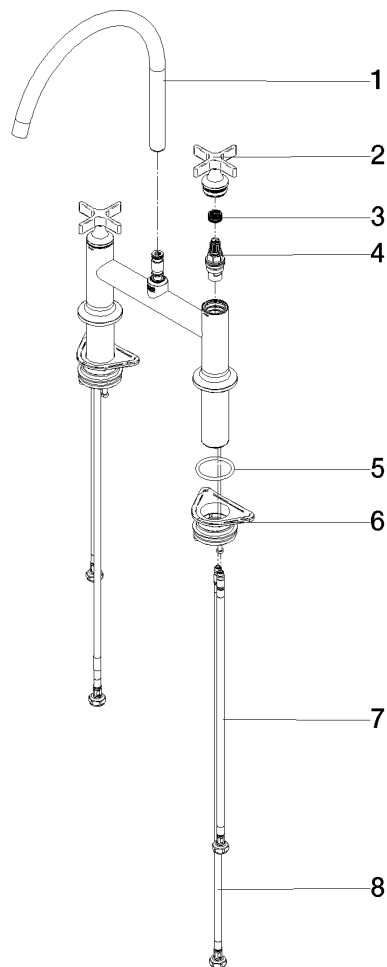

## Spare parts list

No.	Item Number	Name	Quantity used	Delivery time
4	90 90 03 131 00 90	top	2.00	2
1	90 28 22 396 01-06	spout	1.00	10
3	90 12 12 232 00 90	fixing cap	2.00	2
2	90 20 80 036 00-06	handle	2.00	10
6	04 30 11 040 00 90	fixing set	2.00	2
8	04 30 04 103 00 90	hose	2.00	2
5	90 14 10 043 00 90	seal	2.00	2
7	04 30 04 100 00 90	hose	2.00	2