

MEM Three-hole basin mixer with pop-up waste - Brushed Dark Brass

MEM

20 713 782 Product version from 3/10/2014



- 165mm projection
- 1 1/4" pop-up waste
- fixed spout
- rectangular, air-enriched flow
- height of mixer 277 mm
- height up to aerator 170 mm
- hole diameter spout 35 mm
- hole diameter valve 32 mm
- rosette 60 x 60 mm
- 2x screw-in M 10 x 1 pressure hose, leak-tested
- max. flow 4.5 l/min
- lead-free
- This product can help a building meet the requirements of Green Building Rating Systems, e.g. LEED®, BREEAM®, DGNB

Only suitable for basins with an overflow.

	Brushed Dark Brass	20 713 782-39 0010
	Chrome	20 713 782-00 0010
	Brushed Platinum	20 713 782-06 0010
	Platinum	20 713 782-08 0010
	Dark Chrome	20 713 782-19 0010
	Brushed Durabronze (23kt Gold)	20 713 782-28 0010
	Brushed Champagne (22kt Gold)	20 713 782-46 0010
	Champagne (22kt Gold)	20 713 782-47 0010
	Brushed Dark Platinum	20 713 782-99 0010

MEM Three-hole basin mixer with pop-up waste - Brushed Dark Brass

MEM

20 713 782 Product version from 3/10/2014

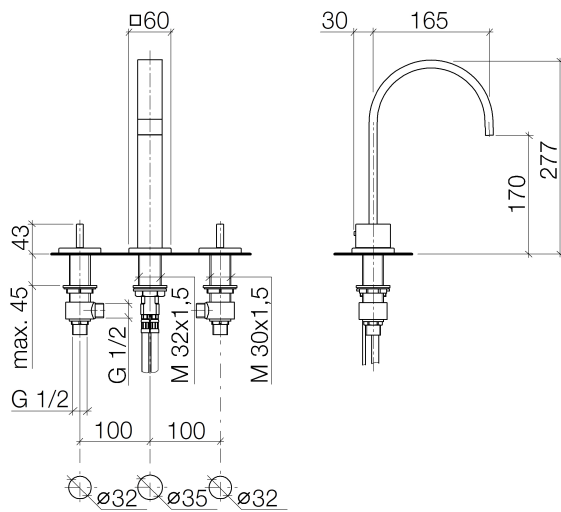

Codes & Standards

ADA	California Energy Commission (CEC)	NSF372	NSF61
-----	------------------------------------	--------	-------

Certificates and sustainability

IAPMO_N-4 IAPMO_6

20 713 782 Product version from 3/10/2014

Parts for other
finishes can be found
here: [Chrome](#)

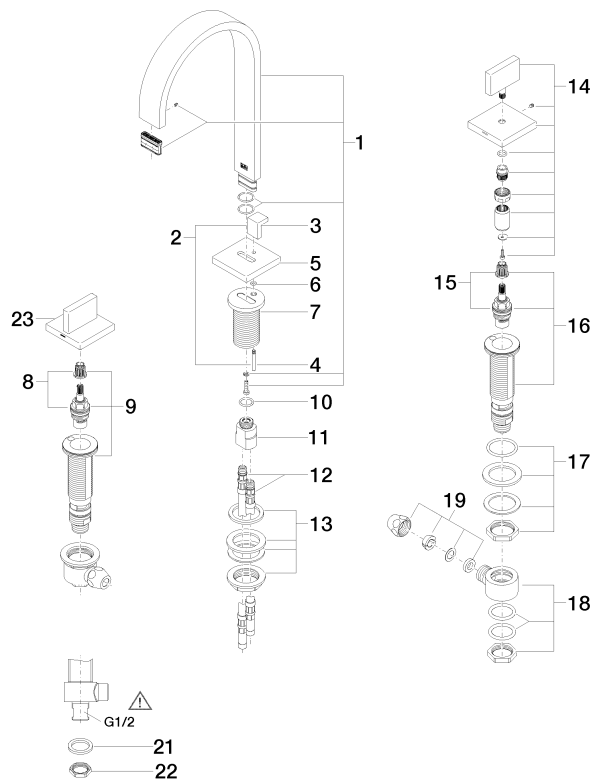

20 Abbildungscode 94.11.01.002.00-0

MEM Three-hole basin mixer with pop-up waste - Brushed Dark Brass

MEM

20 713 782 Product version from 3/10/2014

Spare parts list

No.	Item Number	Name	Quantity used	Delivery time
17	04 23 10 032 78 90	fixing set	2.00	2
21	09 30 11 059 90	disc	2.00	2
14	90 20 78 002 04-39	handle (cold)	1.00	30
22	09 23 10 012 90	nut	2.00	2
1	90 28 22 158 01-39	spout	1.00	30
2	04 20 78 030 80-39	pull-rod	1.00	-
Spare part can no longer be ordered, please order the replacement item				
8	90 90 03 152 00 90	top	1.00	2
23	90 20 78 002 05-39	handle (hot)	1.00	30
20	90 11 01 023 00-39	pop-up waste	1.00	30
3	09 20 78 030-39	handle	1.00	60
6	09 14 10 166 90	seal	1.00	2
16	04 17 11 058 53 90	side panel	1.00	2
12	04 30 04 016 00 90	hose	2.00	60
5	09 27 78 032-39	rosette	1.00	60
15	90 90 03 153 00 90	top	1.00	2
19	90 23 30 040 00-39	threaded connector	2.00	30
10	09 14 10 130 90	seal	1.00	2
13	04 23 10 009 01 90	fixing set	1.00	2
4	09 31 09 080-39	pull-rod	1.00	60
9	04 17 11 058 52 90	side panel	1.00	2
11	09 11 10 055 10 90	connection	1.00	2
18	04 17 11 023 10 90	distributor	2.00	2
7	09 11 10 054 10 90	connection	1.00	2