



VAIA Three-hole basin mixer with pop-up waste - Brushed Durabrand (23kt Gold)

VAIA

20 713 809



- 168mm projection
 - 1 1/4" pop-up waste
 - pivotable spout 360°
 - circular, air-enriched flow
 - height of mixer 280 mm
 - height up to aerator 191 mm
 - hole diameter valve 32 mm
 - hole diameter spout 35 mm
 - rosette Ø 60 mm
 - max. flow 4.5 l/min
 - lead-free
 - This product can help a building meet the requirements of Green Building Rating Systems, e.g. LEED®, BREEAM®, DGNB
- Only suitable for basins with an overflow.

	Brushed Durabrand (23kt Gold)	20 713 809-28 0010
	Chrome	20 713 809-00 0010
	Brushed Platinum	20 713 809-06 0010
	Platinum	20 713 809-08 0010
	Dark Chrome	20 713 809-19 0010
	Brushed Bronze	20 713 809-42 0010
	Brushed Champagne (22kt Gold)	20 713 809-46 0010
	Champagne (22kt Gold)	20 713 809-47 0010
	Brushed Dark Platinum	20 713 809-99 0010



VAIA Three-hole basin mixer with pop-up waste - Brushed Durabron (23kt Gold)

VAIA

20 713 809

mm [inches]

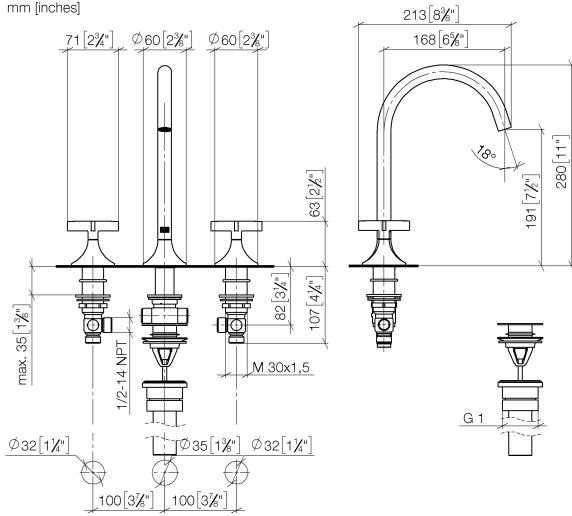

Flow rate chart

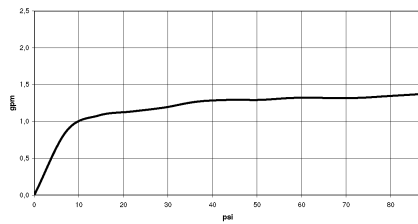

Codes & Standards

ADA

ASME
A112.18.1/CSA
B125.1

California Energy
Commission
(CEC)

NSF/ANSI 372

NSF/ANSI/CAN
61

NSF372

NSF61



VAIA Three-hole basin mixer with pop-up waste - Brushed Durabrass (23kt Gold)

VAIA

20 713 809

Certificates

IAPMO_N-4

IAPMO_6

VAIA Three-hole basin mixer with pop-up waste - Brushed Durabronz (23kt Gold)

VAIA

20 713 809

Product version from 3/13/2017 to 5/27/2021

Product version from 5/27/2021

Parts for other
finishes can be found
here: [Chrome](#)

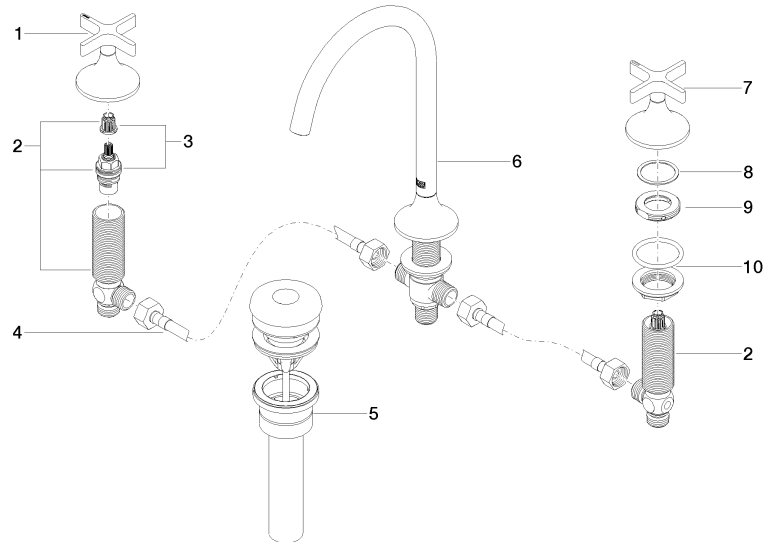



VAIA Three-hole basin mixer with pop-up waste - Brushed Durabrass (23kt Gold)

VAIA

20 713 809

Spare parts list

Product version from 3/13/2017 to 5/27/2021

Product version from 5/27/2021

No.	Item Number	Name	Quantity used	Delivery time
	90 20 80 011 00-28	handle (hot)	16	20