

MEM Three-hole basin mixer with pop-up waste - Platinum

MEM

20 715 782 Product version from 3/10/2014



- 200mm projection
- fixed spout
- 1 1/4" pop-up waste
- rectangular, air-enriched flow
- height of mixer 320 mm
- height up to aerator 195 mm
- hole diameter spout 35 mm
- hole diameter valve 32 mm
- rosette 60 x 60 mm
- 2x screw-in M 10 x 1 pressure hose, leak-tested
- max. flow 4.5 l/min
- lead-free
- This product can help a building meet the requirements of Green Building Rating Systems, e.g. LEED®, BREEAM®, DGNB

Only suitable for basins with an overflow.

	Platinum	20 715 782-08 0010
	Chrome	20 715 782-00 0010
	Brushed Platinum	20 715 782-06 0010
	Dark Chrome	20 715 782-19 0010
	Brushed Durabronze (23kt Gold)	20 715 782-28 0010
	Brushed Champagne (22kt Gold)	20 715 782-46 0010
	Champagne (22kt Gold)	20 715 782-47 0010
	Brushed Dark Platinum	20 715 782-99 0010

MEM Three-hole basin mixer with pop-up waste - Platinum

MEM

20 715 782 Product version from 3/10/2014

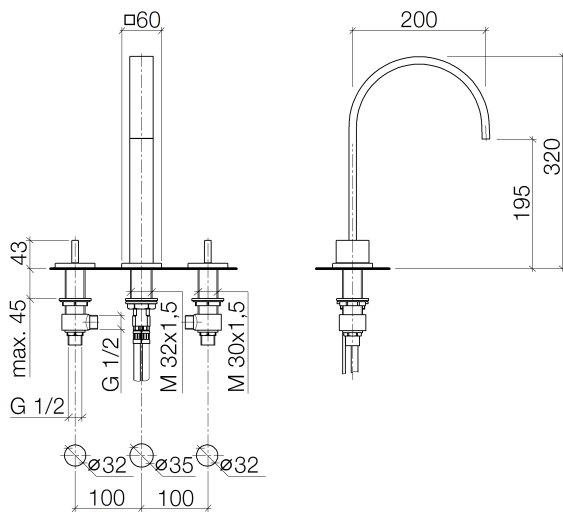

Codes & Standards

ADA	ASME A112.18.1	California Energy Commission (CEC)	cUPC
EPA WaterSense	NSF372	NSF61	WaterSense



Certificates and sustainability

IAPMO_8834	IAPMO_N-4	IAPMO_4976	IAPMO_6
------------	-----------	------------	---------

MEM Three-hole basin mixer with pop-up waste - Platinum

MEM

20 715 782 Product version from 3/10/2014

Parts for other
finishes can be found
here: [Chrome](#)

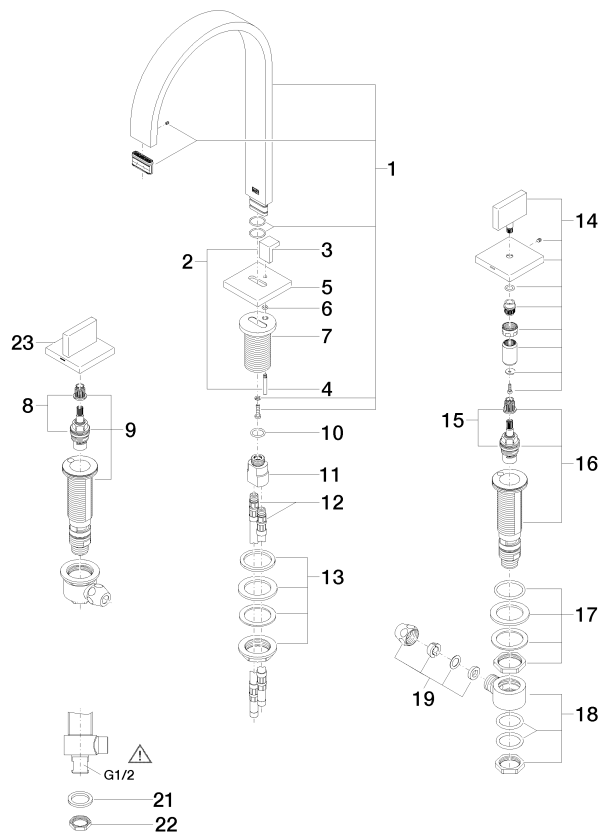

20 ———— Abbildung 06/11.01.003.00 9



MEM Three-hole basin mixer with pop-up waste - Platinum

MEM

20 715 782 Product version from 3/10/2014

Spare parts list

No.	Item Number	Name	Quantity used	Delivery time
7	09 11 10 054 10 90	connection	1.00	2
6	09 14 10 166 90	seal	1.00	2
2	04 20 78 030 80-08	pull-rod	1.00	40
1	90 28 22 155 02-08	spout	1.00	40
8	90 90 03 152 00 90	top	1.00	2
9	04 17 11 058 52 90	side panel	1.00	2
4	09 31 09 080-08	pull-rod	1.00	40
10	09 14 10 130 90	seal	1.00	2
5	09 27 78 032-08	rosette	1.00	40
3	09 20 78 030-08	handle	1.00	40
20	90 11 01 023 00-08	pop-up waste	1.00	40
17	04 23 10 032 78 90	fixing set	1.00	2
14	90 20 78 002 04-08	handle (cold)	1.00	40
19	90 23 30 040 00-08	threaded connector	1.00	40
15	90 90 03 153 00 90	top	1.00	2
23	90 20 78 002 05-08	handle (hot)	1.00	40
13	04 23 10 009 01 90	fixing set	1.00	2
21	09 30 11 059 90	disc	2.00	2
11	09 11 10 055 10 90	connection	1.00	2
22	09 23 10 012 90	nut	2.00	2
18	04 17 11 023 10 90	distributor	1.00	2
16	04 17 11 058 53 90	side panel	1.00	2
12	04 30 04 016 00 90	hose	1.00	60