

VAIA Single-hole basin mixer with pop-up waste - Platinum

VAIA

22 513 809



- 167mm projection
- 1 1/4" pop-up waste
- pivotable spout 360°
- circular, air-enriched flow
- height of mixer 307 mm
- height up to aerator 221 mm
- hole diameter 35 mm
- rosette Ø 60 mm
- 2x screw-in M 10 x 1 pressure hose, leak-tested
- 2x US pressure hose, 3/8"
- max. flow 4.5 l/min
- lead-free
- This product can help a building meet the requirements of Green Building Rating Systems, e.g. LEED®, BREEAM®, DGNB

Only suitable for basins with an overflow.

| | | |
|--|--------------------------------|--------------------|
|  | Platinum | 22 513 809-08 0010 |
|  | Chrome | 22 513 809-00 0010 |
|  | Brushed Platinum | 22 513 809-06 0010 |
|  | Dark Chrome | 22 513 809-19 0010 |
|  | Brushed Durabronze (23kt Gold) | 22 513 809-28 0010 |
|  | Brushed Bronze | 22 513 809-42 0010 |
|  | Brushed Champagne (22kt Gold) | 22 513 809-46 0010 |
|  | Champagne (22kt Gold) | 22 513 809-47 0010 |
|  | Brushed Dark Platinum | 22 513 809-99 0010 |

22 513 809

mm [inches]

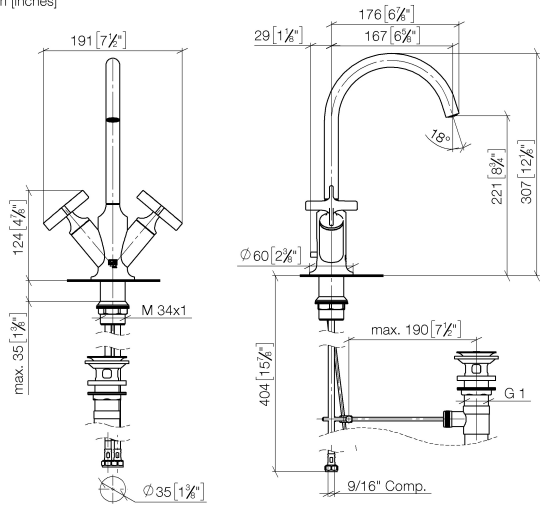

Flow rate chart

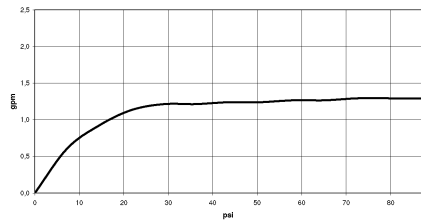

Codes & Standards

California Energy
Commission
(CEC)

22 513 809

Parts for other
finishes can be found
here: [Chrome](#)

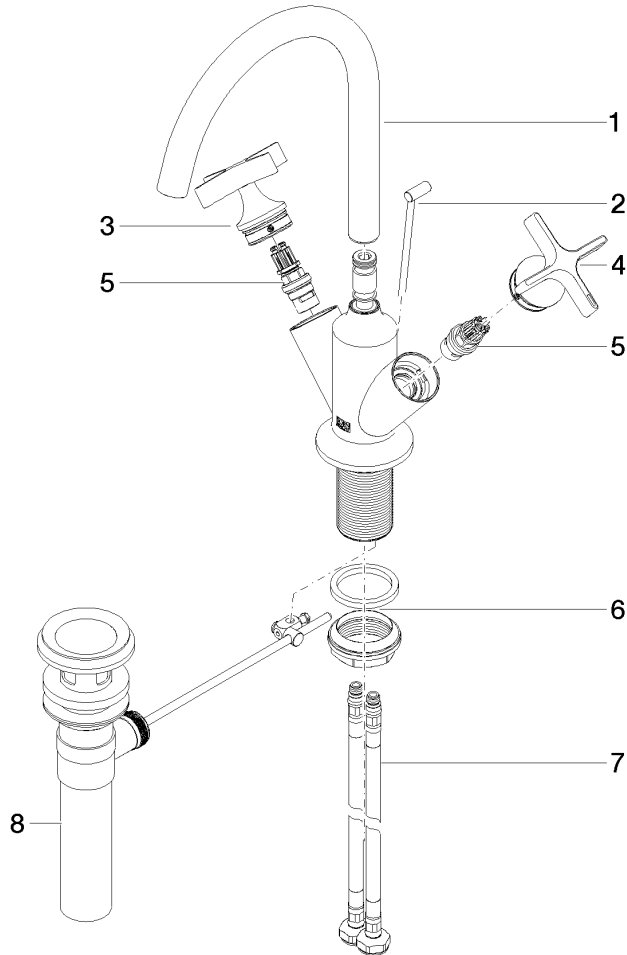



VAIA Single-hole basin mixer with pop-up waste - Platinum

VAIA

22 513 809

Spare parts list

| No. | Item Number | Name | Quantity used | Delivery time |
|-----|--------------------|-------|---------------|---------------|
| | 90 28 22 320 01-08 | spout | 10 | 40 |