

## Shower set without hand shower - Chrome

TARA

26 413 625 Product version from 10/1/2023



Fits: TARA, META

- slide bar
- Pipe diameter 18 mm
- rosette Ø 55 mm
- gauge 800 mm
- metal shower hose 1750mm with integrated anti-twist protection
- shower hose connector 3/8"
- WRAS

This article does not include a hand shower!

NOTE: Hand shower sold separately. Please see hand shower options under the miscellaneous articles section of each series.

	Chrome	26 413 625-00
	Brushed Platinum	26 413 625-06
	Platinum	26 413 625-08
	Dark Chrome	26 413 625-19
	Light Gold	26 413 625-26
	Brushed Light Gold	26 413 625-27
	Brushed Durabronze (23kt Gold)	26 413 625-28
	Matte Black	26 413 625-33
	Brushed Bronze	26 413 625-42
	Brushed Champagne (22kt Gold)	26 413 625-46
	Champagne (22kt Gold)	26 413 625-47
	Brushed Chrome	26 413 625-93
	Brushed Dark Platinum	26 413 625-99

### Recommended miscellaneous

	<b>Concealed adapter -</b>	35 080 970-0010
--	----------------------------	-----------------

### Required miscellaneous

	<b>Hand shower FlowReduce - Chrome</b>	28 016 979-00010
--	--	------------------

### Required miscellaneous

	<b>Hand shower FlowReduce - Chrome</b>	28 018 979-00010
--	--	------------------

### Required miscellaneous

	<b>SERIES-VARIOUS Hand shower FlowReduce - Chrome</b>	28 029 979-00010
--	---	------------------

### Recommended miscellaneous

	<b>Wall elbow - Chrome</b>	28 450 625-00
--	----------------------------	---------------

### Required miscellaneous

	<b>Hand shower FlowReduce - Chrome</b>	28 012 979-00010
--	--	------------------

### Required miscellaneous

	<b>SERIES-VARIOUS Hand shower FlowReduce - Chrome</b>	28 027 979-00010
--	---	------------------

### Required miscellaneous

	<b>SERIES-VARIOUS Hand shower FlowReduce - Chrome</b>	28 025 979-00010
--	---	------------------

Shower set without hand shower - Chrome

TARA

26 413 625    Product version from 10/1/2023

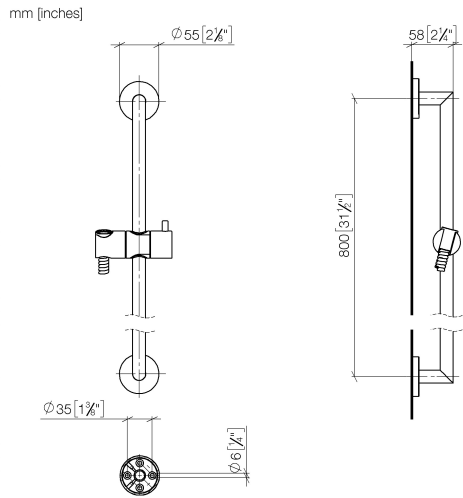

Codes & Standards

Scottish Water Byelaws	UK Water Supply Regulations	XP P 41-280
---------------------------	--------------------------------	-------------

Certificates

WRAS_2009	ACS_20 ACC LY
-----------	---------------

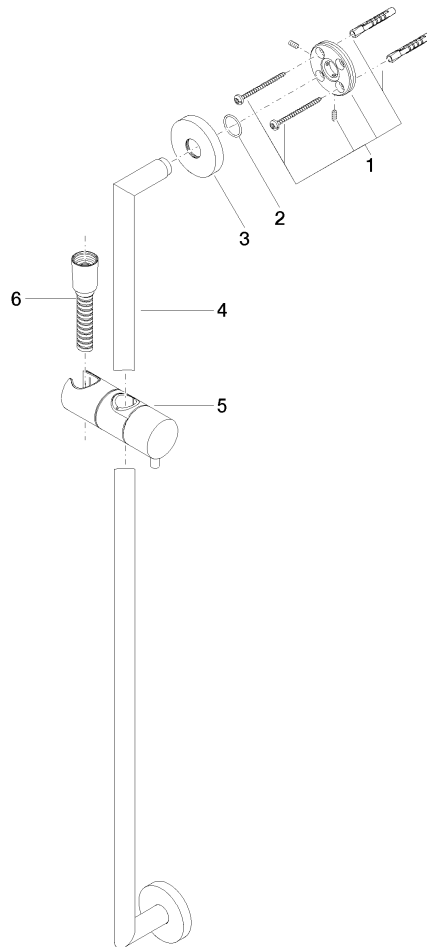

## Spare parts list

No.	Item Number	Name	Quantity used	Delivery time
1	05 17 62 500 00 90	fixing set	2	2
2	90 14 10 032 00 90	seal	2	2
3	08 27 62 500-00	rosette	2	10
4	05 28 22 590 01-00	bar	1	10
5	12 580 970-00	Slide unit - Chrome	1	10
6	28 322 970-00	Metal shower hose 1/2" x 3/8" x 1750 mm - Chrome	1	2