

Shower set without hand shower - Platinum

SERIES SPECIFIC

26 413 980 Product version from 6/1/2024



- slide bar
- Pipe diameter 18 mm
- rosette 60 x 60 mm
- gauge 800 mm
- metal shower hose 1750mm with integrated anti-twist protection
- shower hose connector 3/8"
- WRAS

This article does not include a hand shower!

NOTE: Hand shower sold separately. Please see hand shower options under the miscellaneous articles section of each series.

This article does not include a hand shower!

NOTE: Hand shower sold separately. Please see hand shower options under the miscellaneous articles section of each series.

	Platinum	26 413 980-08
	Chrome	26 413 980-00
	Brushed Platinum	26 413 980-06
	Dark Chrome	26 413 980-19
	Brushed Light Gold	26 413 980-27
	Brushed Durabrass (23kt Gold)	26 413 980-28
	Matte Black	26 413 980-33
	Brushed Champagne (22kt Gold)	26 413 980-46
	Champagne (22kt Gold)	26 413 980-47
	Brushed Chrome	26 413 980-93
	Brushed Dark Platinum	26 413 980-99

Required miscellaneous

	Concealed adapter -	35 080 970-90 0010
---	----------------------------	--------------------

Required miscellaneous

	Hand shower FlowReduce - Platinum	28 012 979-08 0010
---	--	--------------------

Required miscellaneous

	Hand shower FlowReduce - Platinum	28 018 979-08 0010
---	--	--------------------

Required miscellaneous

	SERIES-VARIOUS Hand shower FlowReduce - Platinum	28 025 979-08 0010
---	---	--------------------

Required miscellaneous

	Hand shower FlowReduce - Platinum	28 016 979-08 0010
---	--	--------------------

Recommended miscellaneous

	Wall elbow - Platinum	28 450 980-08
---	------------------------------	---------------

Required miscellaneous

	SERIES-VARIOUS Hand shower FlowReduce - Platinum	28 027 979-08 0010
---	---	--------------------

Required miscellaneous

	SERIES-VARIOUS Hand shower FlowReduce - Platinum	28 029 979-08 0010
---	---	--------------------

26 413 980 Product version from 6/1/2024

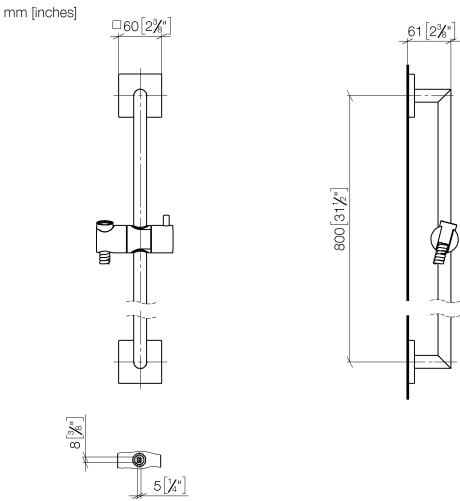

Codes & Standards			
ASME A112.18.1	cUPC	Scottish Water Byelaws	UK Water Supply Regulations
XP P 41-280			

Certificates and sustainability		
WRAS_2009	ACS_20 ACC LY	IAPMO_4976

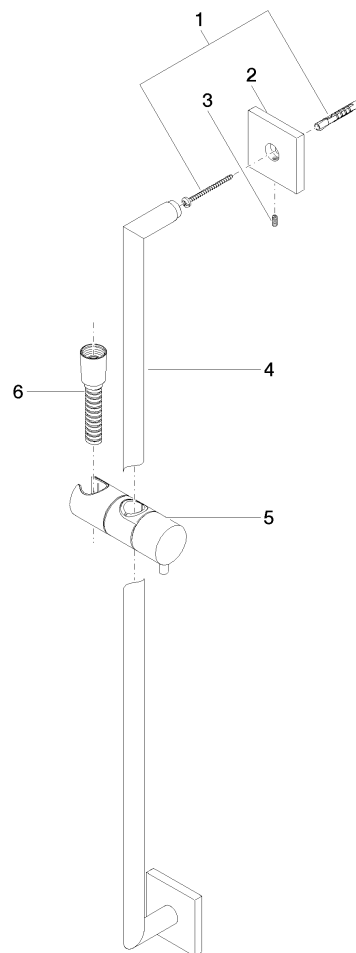

Spare parts list

No.	Item Number	Name	Quantity used	Delivery time
4	05 28 22 590 01-08	bar	1.00	40
6	28 322 970-08	Metal shower hose 1/2" x 3/8" x 1750 mm - Platinum	1.00	40
3	09 31 11 061 90	pin	2.00	2
1	05 30 31 025 00 90	fixing set	2.00	2
2	08 17 98 507-08	holder	2.00	40
5	12 580 970-08	Slide unit - Platinum	1.00	40