

**LISSE Three-hole single-lever bath mixer for bath rim or tile edge installation -
Brushed Light Gold**

LISSE







27 412 845 Product version from 4/1/2024

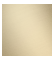

- spout: circular, air-enriched flow
- max. flow 16.9 l/min at 3 bar flow pressure
- Hand shower: COMPACT RAIN, max. flow rate 6.8 l/min (at 3 bar)
- complete hand shower set with anti-scale system
- 200mm projection
- automatic bath/shower diverter
- height of mixer 141 mm
- height up to aerator 88 mm
- hole diameter spout 32 mm
- hole diameter single-lever mixer 35 mm
- hole diameter for complete hand shower set 32 mm
- rosette for complete hand shower set Ø 50mm
- metal shower hose 1750mm with integrated anti-twist protection

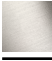
Note: Local building codes may require the use of an anti-scald device. Please refer to remote pressure balance valve (35 910 970 90)

Intrinsic protection against back flow.

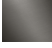
| | | |
|---|-----------------------|---------------|
|  | Brushed Light Gold | 27 412 845-27 |
|  | Chrome | 27 412 845-00 |
|  | Brushed Platinum | 27 412 845-06 |
|  | Dark Chrome | 27 412 845-19 |
|  | Matte Black | 27 412 845-33 |
|  | Brushed Chrome | 27 412 845-93 |
|  | Brushed Dark Platinum | 27 412 845-99 |

LISSÉ Three-hole single-lever bath mixer for bath rim or tile edge installation - Brushed Light Gold

LISSÉ

27 412 845 Product version from 4/1/2024

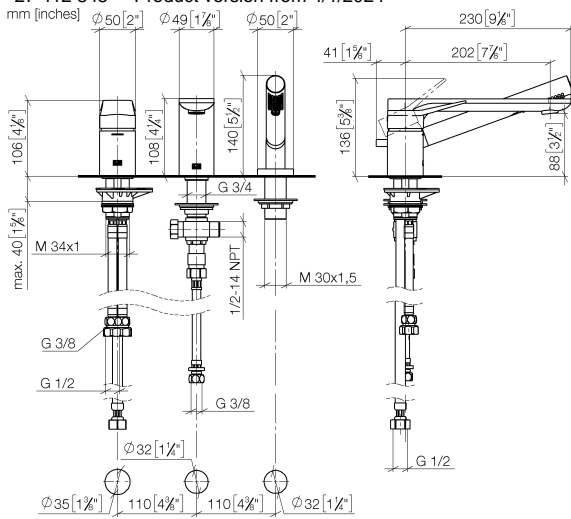

Flow rate chart

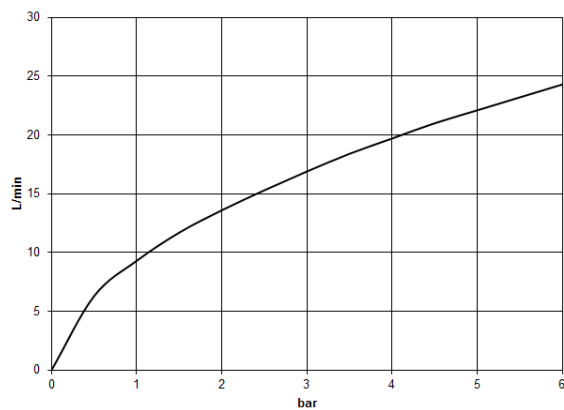

Codes & Standards

California Energy
Commission
(CEC)

EN 1717



LISSE Three-hole single-lever bath mixer for bath rim or tile edge installation - Brushed Light Gold

LISSE

27 412 845 Product version from 4/1/2024

Certificates and sustainability

Belgaqua_24-008-2

LISSE Three-hole single-lever bath mixer for bath rim or tile edge installation -
Brushed Light Gold

LISSE

27 412 845 Product version from 4/1/2024
Parts for other
finishes can be found
here: [Chrome](#)

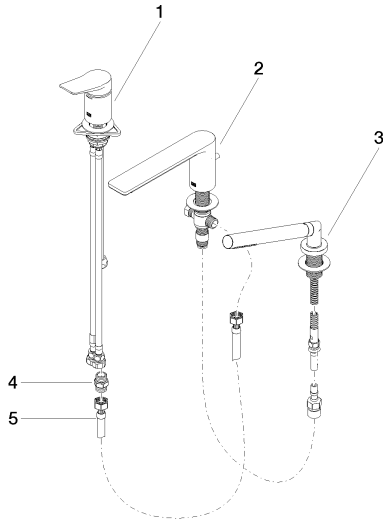

Spare parts list

| No. | Item Number | Name | Quantity used | Delivery time |
|--|--------------------|---|---------------|---------------|
| 4 | 90 24 03 168 00 90 | nipple | 1.00 | 2 |
| 5 | 12 502 970 90 | High pressure hose 1/2" x 1/2" x 400 mm - | 1.00 | 2 |
| 1 | 29 300 845-27 | connection | 1.00 | - |
| Spare part can no longer be ordered, please order the replacement item | | | | |
| 3 | 27 702 979-27 | shower set | 1.00 | 30 |
| 2 | 13 512 845-27 | spout | 1.00 | - |
| Spare part can no longer be ordered, please order the replacement item | | | | |