

Hand shower set with integrated shower holder FlowReduce - Brushed
Champagne (22kt Gold)

SERIES SPECIFIC

27 802 660

Product version from 10/1/2023



- COMPACT RAIN, max. flow rate 6.8 l/min (at 3 bar)
- with anti-scale system
- 3/8" shower outlet
- metal shower hose 1250mm with integrated anti-twist protection
- rosette Ø 60 mm
- 1/2" connection
- This product reduces water consumption by 28% (compared to requirements of EPAct '92)
- This product can contribute to Water Use Reduction in LEED® Green Building Rating
- This product can help a building meet the requirements of Green Building Rating Systems, e.g. LEED®, BREEAM®, DGNB

Intrinsic protection against back flow.

	Brushed Champagne (22kt Gold)	27 802 660-46 0010
	Chrome	27 802 660-00 0010
	Brushed Platinum	27 802 660-06 0010
	Platinum	27 802 660-08 0010
	Dark Chrome	27 802 660-19 0010
	Light Gold	27 802 660-26 0010
	Brushed Light Gold	27 802 660-27 0010
	Brushed Durabronze (23kt Gold)	27 802 660-28 0010
	Matte Black	27 802 660-33 0010
	Brushed Dark Brass	27 802 660-39 0010
	Brushed Bronze	27 802 660-42 0010
	Champagne (22kt Gold)	27 802 660-47 0010
	Brushed Chrome	27 802 660-93 0010
	Brushed Dark Platinum	27 802 660-99 0010



Hand shower set with integrated shower holder FlowReduce - Brushed
Champagne (22kt Gold)

SERIES SPECIFIC

27 802 660 Product version from 10/1/2023

mm [inches]

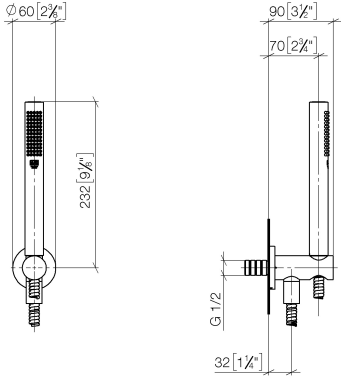

Codes & Standards			
California Energy Commission (CEC)	DIN 4109	ISO 3822	Ü-Zeichen

Certificates and sustainability

LGA_29

Hand shower set with integrated shower holder FlowReduce - Brushed Champagne (22kt Gold)

SERIES SPECIFIC

27 802 660 Product version from 10/1/2023

Parts for other
finishes can be found
here: [Chrome](#)

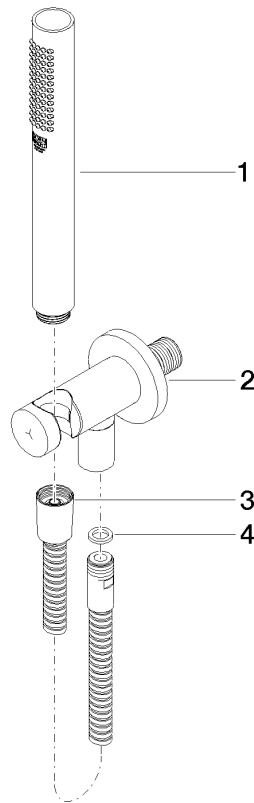

Spare parts list

No.	Item Number	Name	Quantity used	Delivery time
3	90 30 02 072 00-46	Metal shower hose 1/2" x 3/8" x 1250 mm - Brushed Champagne (22kt Gold)	1.00	30
2	28 490 660-46	Wall elbow with integrated shower holder - Brushed Champagne (22kt Gold)	1.00	30
4	90 14 20 026 00 90	seal	1.00	2
1	90 12 11 140 41-46	shower	1.00	30