

Rain shower for surface-mounted ceiling installation with light 300 mm - Brushed Bronze

SERIES SPECIFIC

28 032 970 Product version from 5/1/2022



- rain shower Ø 300 mm
- PURE RAIN, max. flow rate 6.8 l/min (at 3 bar)
- PURIFY RAIN, max. flow rate 6 l/min (at 3 bar)
- Distance to ceiling from bottom edge of shower 40 mm
- with anti-scale system

Ceiling module power supply

- 350mA (CC)

Spot lighting

- LED colour temperature approx. 3000 K
- Bulbs protected against splashing water
- Contains energy efficiency class bulbs
- Technology: LED, not dimmable
- Provided by customer: Light switch

Environment

- Not suitable for outdoor use.
- Not suitable for use in a steam room.
- Not suitable for use in chlorinated or salty environments.
- Comply with the protection zone regulations as defined in DIN VDE 0100, Part 701 (IEC 60364-7-701).

To meet the North American plumbing standards, this application must be installed with three-way diverter (rough included).

To meet the North American plumbing standards, this application must be installed with three-way diverter (rough included).

| | | |
|---|--------------------------------|--------------------|
|  | Brushed Bronze | 28 032 970-42 0010 |
|  | Chrome | 28 032 970-00 0010 |
|  | Brushed Platinum | 28 032 970-06 0010 |
|  | Platinum | 28 032 970-08 0010 |
|  | Dark Chrome | 28 032 970-19 0010 |
|  | Light Gold | 28 032 970-26 0010 |
|  | Brushed Light Gold | 28 032 970-27 0010 |
|  | Brushed Durabronze (23kt Gold) | 28 032 970-28 0010 |
|  | Matte Black | 28 032 970-33 0010 |
|  | Brushed Champagne (22kt Gold) | 28 032 970-46 0010 |
|  | Champagne (22kt Gold) | 28 032 970-47 0010 |
|  | Brushed Chrome | 28 032 970-93 0010 |
|  | Brushed Dark Platinum | 28 032 970-99 0010 |

Required miscellaneous



Concealed ceiling installation box for surface-mounted ceiling installation with light - 35 042 970-90 0010

- min. recess depth 90 mm
- Pre-assembly kit for three-way diverter included
- max. recess depth 115 mm
- Provided by customer: Light switch

Rain shower for surface-mounted ceiling installation with light 300 mm -
Brushed Bronze

SERIES SPECIFIC

28 032 970
Product version from 5/1/2022

mm [inches]

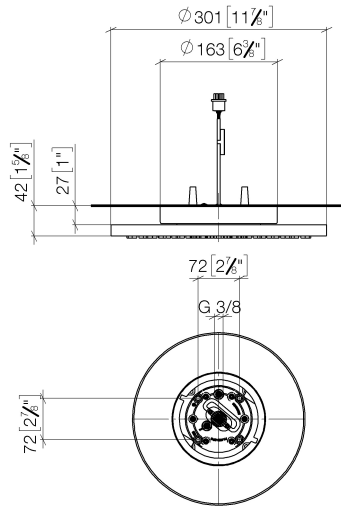

Codes & Standards

| | | | |
|----------------|------------------------------------|------|----------------|
| ASME A112.18.1 | California Energy Commission (CEC) | cUPC | EPA WaterSense |
|----------------|------------------------------------|------|----------------|

WaterSense



Certificates and sustainability

| | |
|------------|-------------|
| IAPMO_4976 | IAPMO_11777 |
|------------|-------------|

Rain shower for surface-mounted ceiling installation with light 300 mm - Brushed Bronze

SERIES SPECIFIC

28 032 970 Product version from 5/1/2022

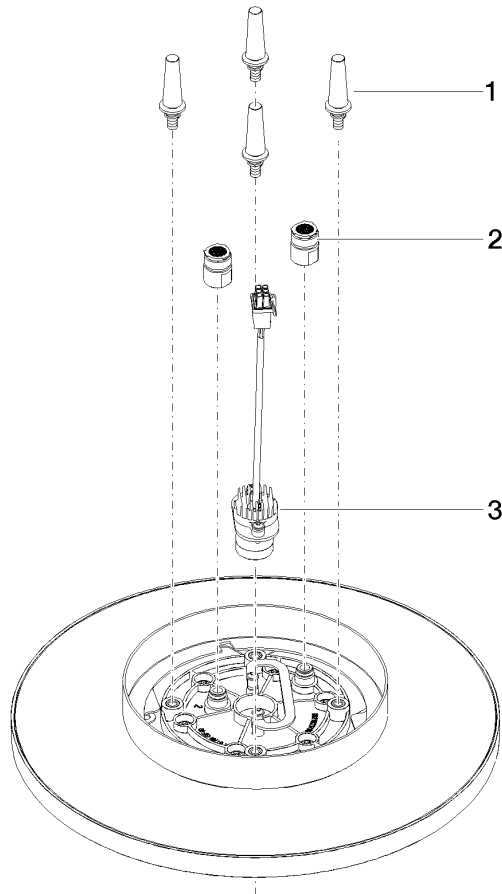

Spare parts list

| No. | Item Number | Name | Quantity used | Delivery time |
|-----|--------------------|------------------------|---------------|---------------|
| 2 | 90 24 03 309 02 90 | connection | 2.00 | 2 |
| 1 | 90 17 20 263 00 90 | fixing set | 1.00 | 2 |
| 3 | 90 10 01 225 00 90 | electronic accessories | 1.00 | 2 |