

Wall bracket - Chrome

28 050 980 Product version from 3/2/2021

- rosette 60 x 60 mm



| | | |
|---|-------------------------------------|---------------|
|  | Chrome | 28 050 980-00 |
|  | Brushed Platinum | 28 050 980-06 |
|  | Platinum | 28 050 980-08 |
|  | Dark Chrome | 28 050 980-19 |
|  | Brushed Light Gold | 28 050 980-27 |
|  | Brushed Durabrass (23kt Gold) | 28 050 980-28 |
|  | Matte Black | 28 050 980-33 |
|  | Brushed Champagne (22kt Gold) | 28 050 980-46 |
|  | Champagne (22kt Gold) | 28 050 980-47 |
| | Cyprum | 28 050 980-49 |
|  | Brushed Chrome | 28 050 980-93 |
|  | Brushed Dark Platinum | 28 050 980-99 |

Wall bracket - Chrome

28 050 980 Product version from 3/2/2021

mm [inches]

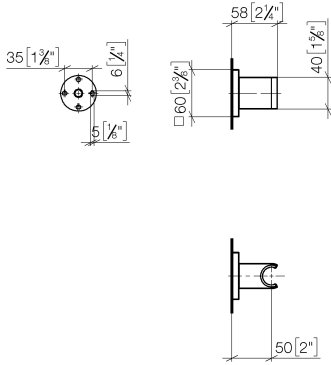

Wall bracket - Chrome

28 050 980 Product version from 3/2/2021

Parts for other
finishes can be found
here: Brushed
Platinum

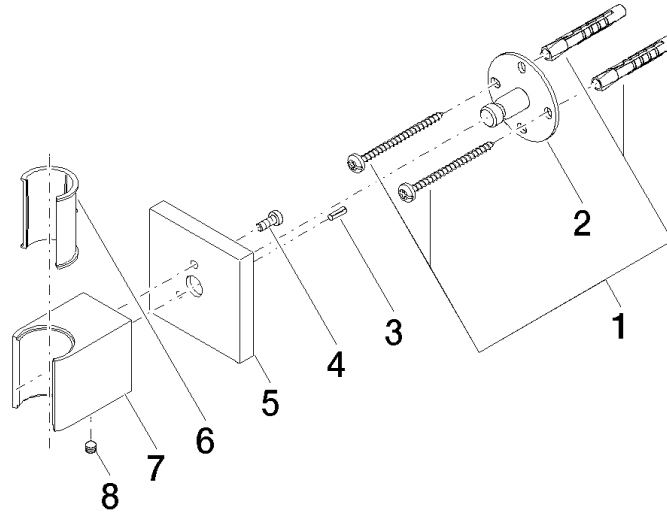

Spare parts list

| No. | Item Number | Name | Quantity used | Delivery time |
|-----|--------------------|------------|---------------|---------------|
| 1 | 05 30 31 025 00 90 | fixing set | 1 | 2 |
| 2 | 09 30 11 041 90 | disc | 1 | 2 |
| 3 | 09 31 11 026 90 | pin | 1 | 2 |
| 4 | 09 30 30 054 90 | screw | 1 | 2 |
| 5 | 09 27 98 002-00 | rosette | 1 | 10 |
| 6 | 09 18 40 078 90 | sleeve | 1 | 2 |
| 7 | 09 17 20 044-00 | holder | 1 | 10 |
| 8 | 90 31 11 112 00 90 | pin | 1 | 2 |