



28 504 831 Product version from 1/1/2023



- 180-210mm projection
- ball-joint pivotable through 30°
- normal flow
- with anti-scale system
- spray head Ø 100mm
- rosette Ø 55 mm
- 1/2" connection
- max. flow 7.6 l/min
- rosette Ø 55 mm

	Chrome	28 504 831-00 0010
<hr/>		
	Soft Black	28 504 831-69 0010

### Recommended miscellaneous

	<b>Concealed wall elbow -</b>	35 085 970-90 0010
---	-------------------------------	-----------------------

mm [inches]

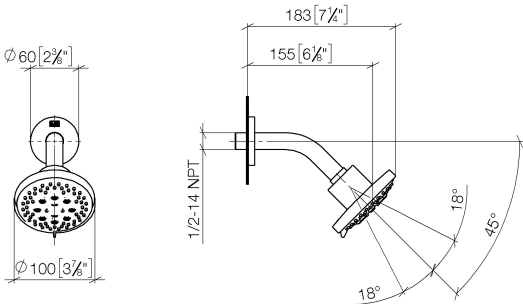

Codes & Standards			
ASME A112.18.1	California Energy Commission (CEC)	cUPC	EPA WaterSense
WaterSense			

Certificates and sustainability	
IAPMO_4976	IAPMO_11777

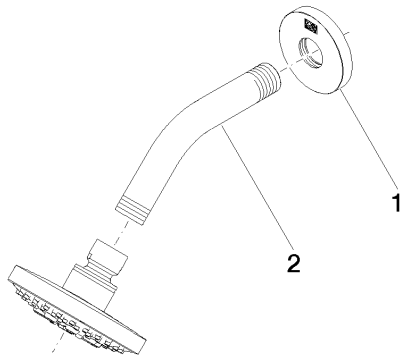

Spare parts list

No.	Item Number	Name	Quantity used	Delivery time
1	90 27 83 018 00-00	rosette	1.00	2
2	90 11 03 011 11-00	connection	1.00	2