





LULU Rain shower with ceiling fixing 300 x 240 mm - Chrome

28 796 710 Product version from 3/13/2017



- PURE RAIN, max. flow rate 6.8 l/min (at 3 bar)
- Function from: 6 l/min
- with anti-scale system
- rain shower 300 x 240mm
- distance between ceiling and lower edge of the shower 165mm
- rosette 78 x 55, as required
- 1/2" connection
- quick clearing
- This product reduces water consumption by 28% (compared to requirements of EPAAct '92)
- This product can contribute to Water Use Reduction in LEED® Green Building Rating
- This product can help a building meet the requirements of Green Building Rating Systems, e.g. LEED®, BREEAM®, DGNB

	Chrome	28 796 710-00 0010
	Brushed Platinum	28 796 710-06 0010

Required miscellaneous

	Concealed wall elbow -	35 085 970-90
	•max. recess depth mm	0010
	•min. recess depth mm	



LULU Rain shower with ceiling fixing 300 x 240 mm - Chrome

28 796 710 Product version from 3/13/2017

mm [inches]

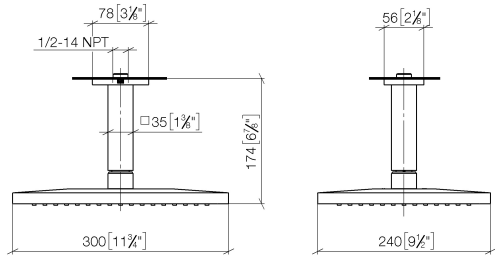

Flow rate chart

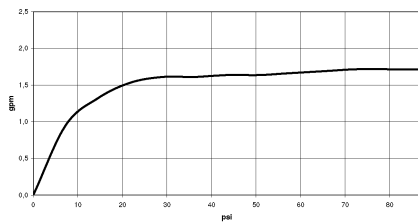

Codes & Standards

ASME A112.18.1	ASME A112.18.1/CSA B125.1	California Energy Commission (CEC)	cUPC
Water Sense			



LULU Rain shower with ceiling fixing 300 x 240 mm - Chrome

28 796 710 Product version from 3/13/2017

Certificates

IAPMO_4976

LULU Rain shower with ceiling fixing 300 x 240 mm - Chrome

28 796 710 Product version from 3/13/2017

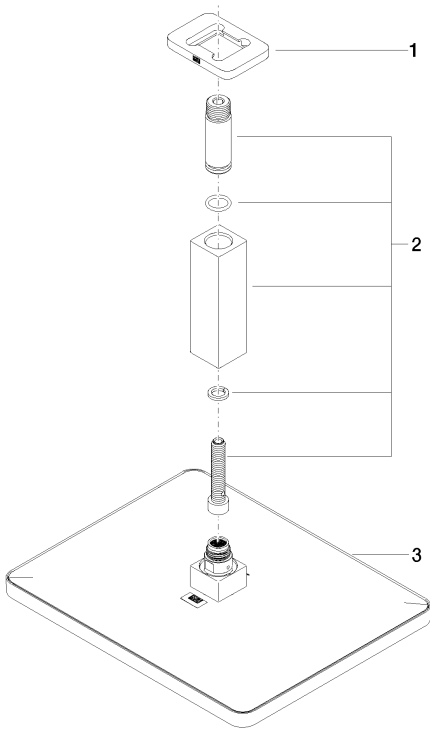

Spare parts list

No.	Item Number	Name	Quantity used	Delivery time
1	09 27 71 020-00	rosette	1	10
2	90 11 10 092 00-00	connection	1	10
3	04 12 05 062 10-00	shower	1	10