

**META Wall-mounted valve cold water without pop-up waste - Brushed Bronze**

30 010 662 Product version from 5/1/2022



- 126mm projection
- fixed spout
- circular, air-enriched flow
- hole diameter 35 mm
- rosette Ø 60 mm
- max. flow 4.5 l/min
- lead-free
- This product can help a building meet the requirements of Green Building Rating Systems, e.g. LEED®, BREEAM®, DGNB

	Brushed Bronze	30 010 662-42 0010
	Chrome	30 010 662-00 0010
	Brushed Platinum	30 010 662-06 0010
	Light Gold	30 010 662-26 0010
	Brushed Light Gold	30 010 662-27 0010
	Matte Black	30 010 662-33 0010
	Brushed Champagne (22kt Gold)	30 010 662-46 0010
	Champagne (22kt Gold)	30 010 662-47 0010
	Brushed Chrome	30 010 662-93 0010
	Brushed Dark Platinum	30 010 662-99 0010

**Recommended miscellaneous**



- Concealed wall elbow -**
- min. recess depth mm
  - max. recess depth mm

35 085 970-90  
0010



# META Wall-mounted valve cold water without pop-up waste - Brushed Bronze

30 010 662    Product version from 5/1/2022

mm [inches]

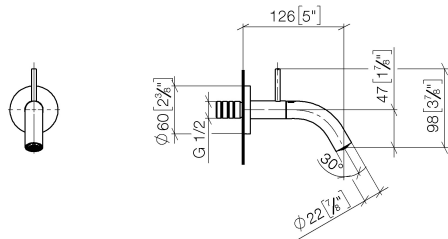

## Flow rate chart

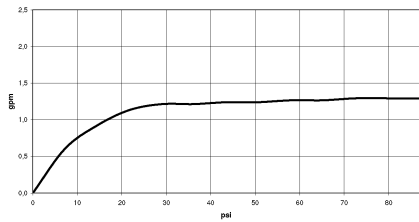

## Codes & Standards

ASME A112.18.1	California Energy Commission (CEC)	cUPC	NSF372
NSF61			



META Wall-mounted valve cold water without pop-up waste - Brushed Bronze

---

30 010 662    Product version from 5/1/2022

Certificates

---

IAPMO\_N-4                      IAPMO\_6                      IAPMO\_4976 (

META Wall-mounted valve cold water without pop-up waste - Brushed Bronze

30 010 662    Product version from 5/1/2022

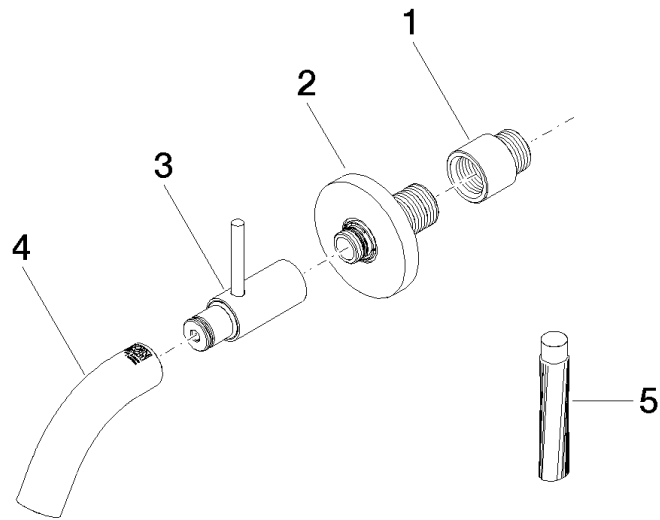

Spare parts list

No.	Item Number	Name	Quantity used	Delivery time
1	09 24 03 072 10 90	nipple	1	2
2	90 27 66 019 00-42	rosette	1	30
3	90 20 66 023 00-42	handle	1	30
4	90 28 22 386 00-42	spout	1	30
5	09 16 03 001 90	grease	1	2