

META Wall-mounted valve cold water without pop-up waste - Brushed Dark Platinum

30 010 662    Product version from 5/1/2022



- 126mm projection
- fixed spout
- circular, air-enriched flow
- hole diameter 35 mm
- rosette Ø 60 mm
- max. flow 4.5 l/min
- lead-free
- This product can help a building meet the requirements of Green Building Rating Systems, e.g. LEED®, BREEAM®, DGNB

	Brushed Dark Platinum	30 010 662-99 0010
	Chrome	30 010 662-00 0010
	Brushed Platinum	30 010 662-06 0010
	Light Gold	30 010 662-26 0010
	Brushed Light Gold	30 010 662-27 0010
	Matte Black	30 010 662-33 0010
	Brushed Bronze	30 010 662-42 0010
	Brushed Champagne (22kt Gold)	30 010 662-46 0010
	Champagne (22kt Gold)	30 010 662-47 0010
	Brushed Chrome	30 010 662-93 0010

Recommended miscellaneous

	<b>Concealed wall elbow -</b>	35 085 970-90
	•min. recess depth mm	0010
	•max. recess depth mm	



# META Wall-mounted valve cold water without pop-up waste - Brushed Dark Platinum

30 010 662    Product version from 5/1/2022  
mm [inches]

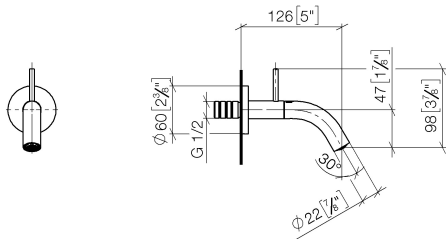

## Flow rate chart

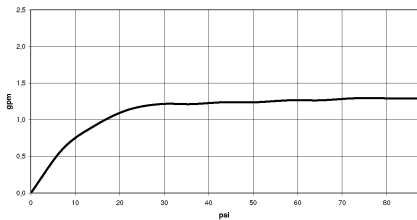

## Codes & Standards

ASME A112.18.1	California Energy Commission (CEC)	cUPC	EPA WaterSense
NSF372	NSF61	Water Sense	WaterSense





META Wall-mounted valve cold water without pop-up waste - Brushed Dark  
Platinum

---

30 010 662    Product version from 5/1/2022

Certificates

---

IAPMO_8834	IAPMO_N-4	IAPMO_6	IAPMO_4976 (
------------	-----------	---------	--------------

META Wall-mounted valve cold water without pop-up waste - Brushed Dark Platinum

30 010 662

Product version from 5/1/2022

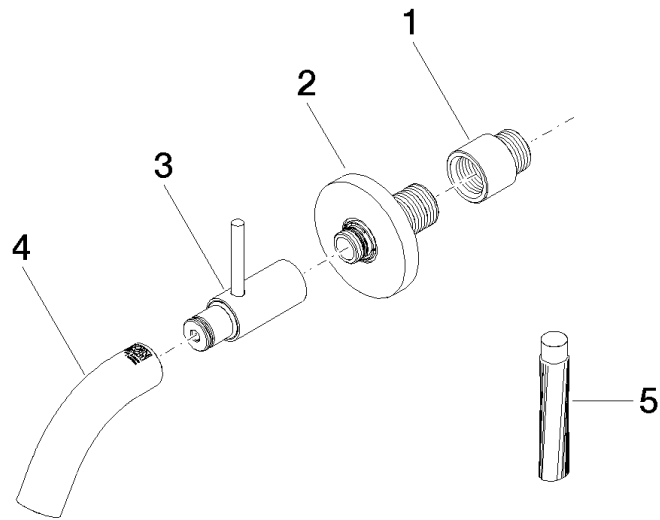

Spare parts list

No.	Item Number	Name	Quantity used	Delivery time
1	09 24 03 072 10 90	nipple	1	2
2	90 27 66 019 00-99	rosette	1	20
3	90 20 66 023 00-99	handle	1	20
4	90 28 22 386 00-99	spout	1	20
5	09 16 03 001 90	grease	1	2