

VAIA Wall-mounted valve cold water without pop-up waste - Champagne (22kt Gold)

VAIA

30 010 809 Product version from 4/1/2025



- 151mm projection
- fixed spout
- circular, air-enriched flow
- adapter with male thread 3/4"
- hole diameter 35 mm
- rosette Ø 60 mm
- max. flow 4.5 l/min
- lead-free
- This product can help a building meet the requirements of Green Building Rating Systems, e.g. LEED®, BREEAM®, DGNB

	Champagne (22kt Gold)	30 010 809-47 0010
	Chrome	30 010 809-00 0010
	Brushed Platinum	30 010 809-06 0010
	Platinum	30 010 809-08 0010
	Dark Chrome	30 010 809-19 0010
	Brushed Durabronze (23kt Gold)	30 010 809-28 0010
	Brushed Dark Brass	30 010 809-39 0010
	Brushed Bronze	30 010 809-42 0010
	Brushed Champagne (22kt Gold)	30 010 809-46 0010
	Brushed Dark Platinum	30 010 809-99 0010

Recommended miscellaneous



Concealed wall elbow -

- min. recess depth 90 mm
- max. recess depth 163 mm

35 085 970-90
0010

VAIA Wall-mounted valve cold water without pop-up waste - Champagne (22kt Gold)

VAIA

30 010 809

Product version from 4/1/2025

mm [inches]

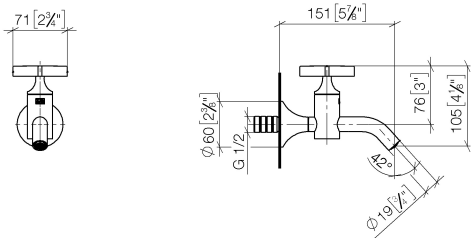

Codes & Standards

ADA	ASME A112.18.1	California Energy Commission (CEC)	cUPC
EPA WaterSense	NSF372	NSF61	WaterSense



Certificates and sustainability

IAPMO_6397	IAPMO_N-4976	IAPMO_8834	IAPMO_4976 (
------------	--------------	------------	--------------

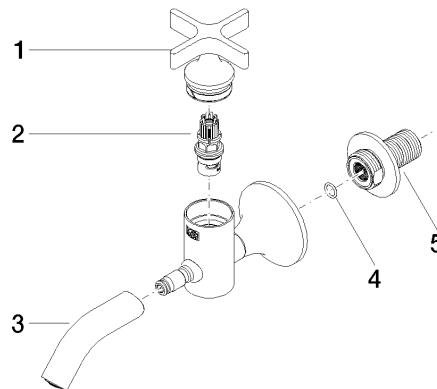

Spare parts list

No.	Item Number	Name	Quantity used	Delivery time
1	90 20 66 025 00-47	handle	1.00	30
3	90 28 22 381 01-47	spout	1.00	30
2	90 90 03 175 00 90	top	1.00	2
5	09 24 03 269 90	nipple	1.00	2
4	90 14 10 060 00 90	seal	1.00	2