

TARA Single-lever mixer - Brushed Bronze

TARA

33 815 888    Product version from 9/7/2021



- 236mm projection
  - pivotable spout 360°
  - air-enriched flow
  - height of mixer 400 mm
  - height up to aerator 230 mm
  - hole diameter 35 mm
  - 2 x pressure hose with 3/8" cap nut
  - max. flow 5.7 l/min at 3 bar flow pressure
  - lead-free
  - This product can help a building meet the requirements of Green Building Rating Systems, e.g. LEED®, BREEAM®, DGNB
- Not possible in combination with rinsing spray.

	Brushed Bronze	33 815 888-42 0010
	Chrome	33 815 888-00 0010
	Brushed Platinum	33 815 888-06 0010
	Platinum	33 815 888-08 0010
	Durabrass (23kt Gold)	33 815 888-09 0010
	Dark Chrome	33 815 888-19 0010
	Brushed Durabrass (23kt Gold)	33 815 888-28 0010
	Matte Black	33 815 888-33 0010
	Brushed Champagne (22kt Gold)	33 815 888-46 0010
	Champagne (22kt Gold)	33 815 888-47 0010
	Brushed Chrome	33 815 888-93 0010
	Brushed Dark Platinum	33 815 888-99 0010

Recommended miscellaneous

AIR SWITCH Control button -  
Brushed Bronze

10 713 970-42



Recommended miscellaneous

Dispenser with rosette - Brushed  
Bronze

82 444 970-42



## TARA Single-lever mixer - Brushed Bronze

TARA

33 815 888 Product version from 9/7/2021

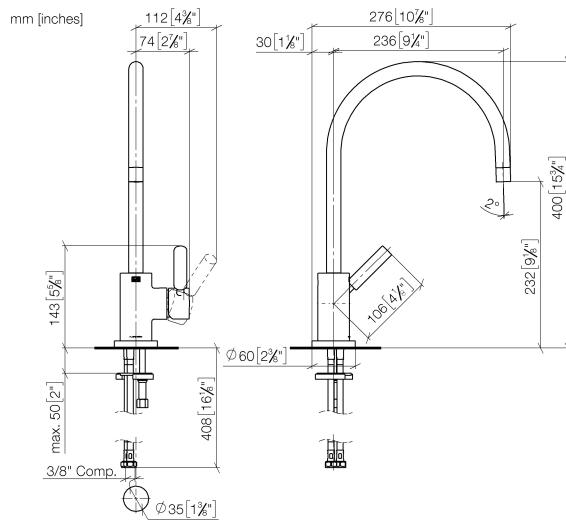

### Codes & Standards

ADA	ASME A112.18.1	California Energy Commission (CEC)	cUPC
NSF372	NSF61		

### Certificates and sustainability

IAPMO\_N-4976 IAPMO\_6397 IAPMO\_4976 (

33 815 888 Product version from 9/7/2021

Parts for other  
finishes can be found  
here: [Chrome](#)

