

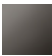





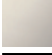

VAIA Single-lever mixer for rinsing/Profi spray - Dark Chrome
VAIA

33 826 809

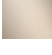

- 241mm projection
  - pivotable spout 360°
  - air-enriched flow
  - max. flow 5.7 l/min at 3 bar flow pressure
  - lead-free
  - This product can help a building meet the requirements of Green Building Rating Systems, e.g. LEED®, BREEAM®, DGNB
- Single-lever mixer for combining with rinsing/Profi spray only

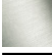
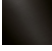
|   |                               |                    |
|---|-------------------------------|--------------------|
|    | Dark Chrome                   | 33 826 809-19 0010 |
|    | Chrome                        | 33 826 809-00 0010 |
|    | Brushed Platinum              | 33 826 809-06 0010 |
|    | Platinum                      | 33 826 809-08 0010 |
|    | Durabrass (23kt Gold)         | 33 826 809-09 0010 |
|    | Brushed Durabrass (23kt Gold) | 33 826 809-28 0010 |
|    | Matte Black                   | 33 826 809-33 0010 |
|    | Brushed Champagne (22kt Gold) | 33 826 809-46 0010 |
|    | Champagne (22kt Gold)         | 33 826 809-47 0010 |
|   | Brushed Chrome                | 33 826 809-93 0010 |
|  | Brushed Dark Platinum         | 33 826 809-99 0010 |

Recommended miscellaneous

VAIA Dispenser with rosette - Dark Chrome
82 434 809-19



Recommended miscellaneous

VAIA AIR SWITCH Control button - Dark Chrome
10 713 809-19



Recommended miscellaneous

VAIA Rinsing spray set - Dark Chrome
27 718 809-19



33 826 809

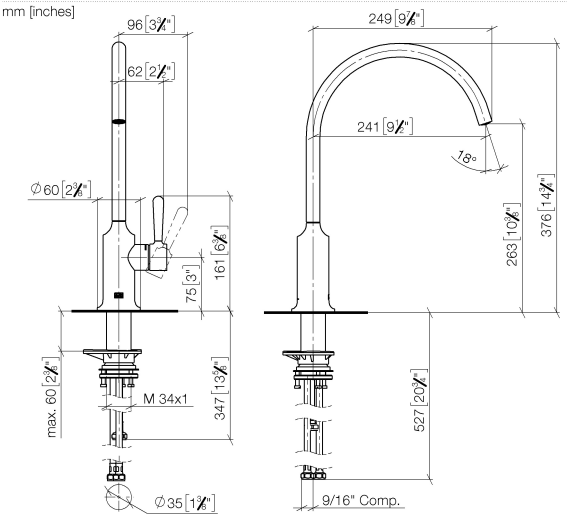

### Flow rate chart

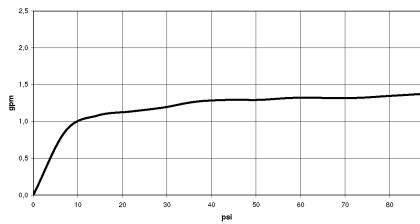

### Codes & Standards

California Energy  
Commission  
(CEC)

33 826 809

Parts for other  
finishes can be found  
here: [Chrome](#)

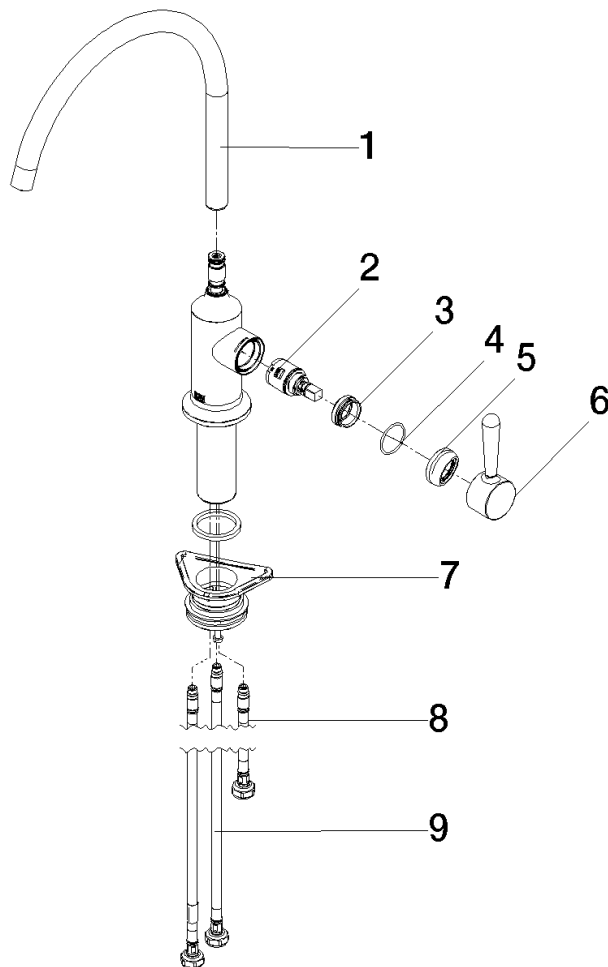

## Spare parts list

| No.  | Item Number        | Name       | Quantity used | Delivery time |
|--|--------------------|------------|---------------|---------------|
| 1  | 90 28 22 396 01-19 | spout      | 1             | -             |
| Spare part can no longer be ordered, please order the replacement item |                    |            |               |               |
| 2  | 90 15 05 042 00 90 | cartridge  | 1             | 2             |
| 3  | 09 24 04 266 90    | nut        | 1             | 2             |
| 4  | 09 14 10 091 90    | seal       | 1             | 2             |
| 5  | 90 28 30 052 00-19 | cover      | 1             | 30            |
| 6  | 90 20 80 050 00-19 | handle     | 1             | -             |
| Spare part can no longer be ordered, please order the replacement item |                    |            |               |               |
| 7  | 04 23 10 044 08 90 | fixing set | 1             | 2             |
| 8  | 04 30 04 100 00 90 | hose       | 1             | 2             |
| 9  | 04 30 04 103 00 90 | hose       | 2             | 2             |