

Showerpipe with shower thermostat without hand shower - Matte Black

IMO

34 459 980



Fits: IMO, MEM, CL.1, CYO

- shower with fixed riser projection 453mm
 - overhead shower: rain flow
 - rain shower 300 x 240mm
 - rain shower with anti-scale system
 - max. rainshower flow 6.8 l/min
 - Function from: 6 l/min
 - rotary diverter with volume control and shut-off function
 - slide-on rosettes Ø 70 mm
 - height of fittings up to rain shower (bottom edge) 1009mm
 - height of fittings up to top edge of elbow 1150mm
 - gauge 150 mm - 13 mm
 - metal shower hose 1750mm with integrated anti-twist protection
 - 1/2" connection
 - slide bar
 - Pipe diameter 23.5 mm
 - quick clearing
 - This product reduces water consumption by % (compared to requirements of EPA '92)
 - This product can contribute to Water Use Reduction in LEED® Green Building Rating
- Intrinsic protection against back flow.**

NOTE: Hand shower sold separately. Please see hand shower options under the miscellaneous articles section of each series.

Intrinsic protection against back flow.

NOTE: Hand shower sold separately. Please see hand shower options under the miscellaneous articles section of each series.

| | | |
|--|--------------------------------|--------------------|
| | Matte Black | 34 459 980-33 0010 |
| | Chrome | 34 459 980-00 0010 |
| | Brushed Platinum | 34 459 980-06 0010 |
| | Platinum | 34 459 980-08 0010 |
| | Dark Chrome | 34 459 980-19 0010 |
| | Brushed Durabronze (23kt Gold) | 34 459 980-28 0010 |
| | Brushed Champagne (22kt Gold) | 34 459 980-46 0010 |
| | Brushed Chrome | 34 459 980-93 0010 |
| | Brushed Dark Platinum | 34 459 980-99 0010 |

Required miscellaneous



Concealed adapter - 35 080 970-90
 • please order two adapters (USA only) 0010

Required miscellaneous



Hand shower FlowReduce - Matte Black 28 016 979-33 0010

Required miscellaneous



Hand shower FlowReduce - Matte Black 28 012 979-33 0010

Required miscellaneous



Hand shower FlowReduce - Matte Black 28 018 979-33 0010

34 459 980

mm [inches]
1:10

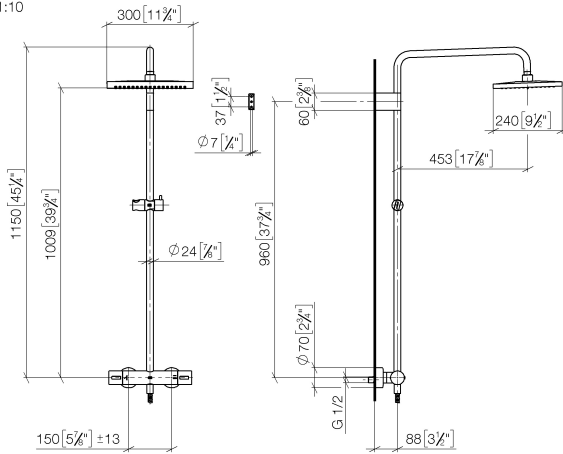

Flow rate chart

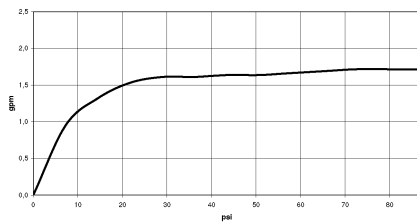

Codes & Standards

ASME
A112.18.1/CSA
B125.1

California Energy
Commission
(CEC)

34 459 980

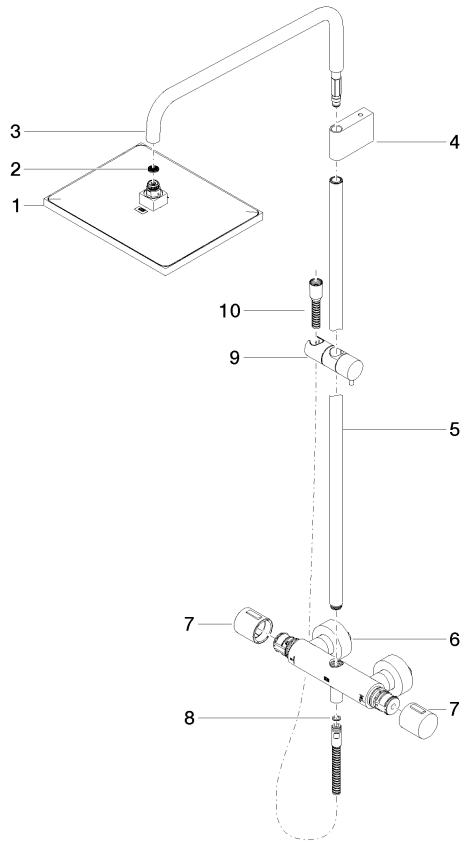

Spare parts list

| No. | Item Number | Name | Quantity used | Delivery time |
|-----|--------------------|---|---------------|---------------|
| 1 | 04 12 05 063 10-33 | shower | 1 | 30 |
| 2 | 09 23 01 039 90 | sieve | 1 | 2 |
| 3 | 90 28 22 348 00-33 | pipe | 1 | 30 |
| 4 | 90 17 11 150 00-33 | holder | 1 | 30 |
| 5 | 90 28 22 349 00-33 | pipe | 1 | 30 |
| 6 | 04 17 01 250 00-33 | connection | 1 | 30 |
| 7 | 90 17 33 015 00-33 | handle | 1 | 30 |
| 8 | 90 14 20 026 00 90 | seal | 1 | 2 |
| 9 | 12 570 970-33 | Slide unit - Matte Black | 1 | 30 |
| 10 | 28 322 970-33 | Metal shower hose 1/2" x 3/8" x 1750 mm - Matte Black | 1 | 2 |