

## Showerpipe with shower thermostat without hand shower - Brushed Chrome

SERIES SPECIFIC

34 459 980 Product version from 6/1/2024



- shower with fixed riser projection 453mm
- overhead shower: rain flow
- rain shower 300 x 240mm
- rain shower with anti-scale system
- max. rainshower flow 6.8 l/min
- Function from: 6 l/min
- rotary diverter with volume control and shut-off function
- slide-on rosettes Ø 70 mm
- height of fittings up to rain shower (bottom edge) 1009mm
- height of fittings up to top edge of elbow 1150mm
- gauge 150 mm - 13 mm
- metal shower hose 1750mm with integrated anti-twist protection
- 1/2" connection
- slide bar
- Pipe diameter 23.5 mm
- quick clearing
- This product reduces water consumption by 28% (compared to requirements of EPAAct '92)
- This product can contribute to Water Use Reduction in LEED® Green Building Rating

Intrinsic protection against back flow.

NOTE: Hand shower sold separately. Please see hand shower options under the miscellaneous articles section of each series.

	Brushed Chrome	34 459 980-93 0010
	Chrome	34 459 980-00 0010
	Brushed Platinum	34 459 980-06 0010
	Platinum	34 459 980-08 0010
	Dark Chrome	34 459 980-19 0010
	Brushed Light Gold	34 459 980-27 0010
	Brushed Durabrass (23kt Gold)	34 459 980-28 0010
	Matte Black	34 459 980-33 0010
	Brushed Champagne (22kt Gold)	34 459 980-46 0010
	Champagne (22kt Gold)	34 459 980-47 0010
	Brushed Dark Platinum	34 459 980-99 0010

34 459 980 Product version from 6/1/2024

mm [inches]  
1:10

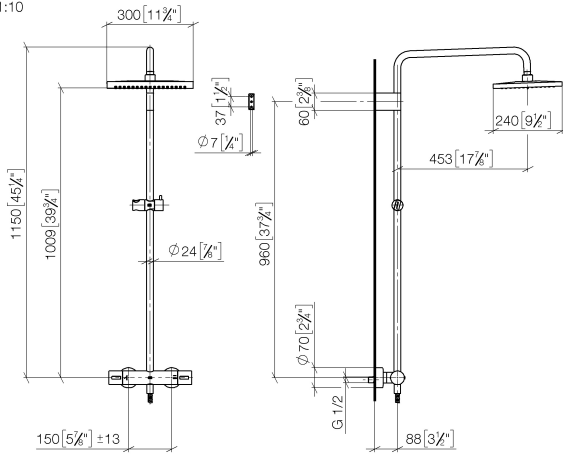

## Codes & Standards

California Energy  
Commission  
(CEC)

34 459 980 Product version from 6/1/2024

Parts for other finishes can be found here: [Chrome](#)

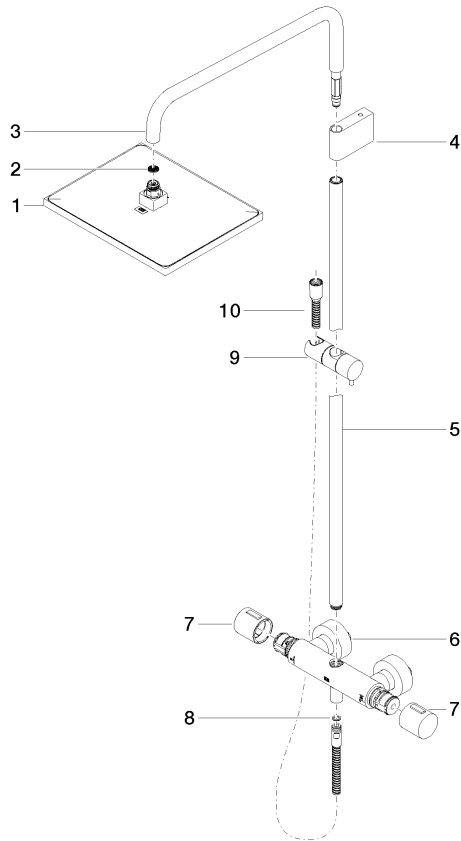

## Spare parts list

No.	Item Number	Name	Quantity used	Delivery time
9	12 570 970-93	Slide unit - Brushed Chrome	1.00	20
10	28 322 970-93	Metal shower hose 1/2" x 3/8" x 1750 mm - Brushed Chrome	1.00	20
6	04 17 01 250 00-93	connection	1.00	20
5	90 28 22 349 00-93	pipe	1.00	20
3	90 28 22 348 00-93	pipe	1.00	20
2	09 23 01 039 90	sieve	1.00	2
1	04 12 05 063 10-93	shower	1.00	20
7	90 17 33 015 00-93	handle	1.00	20
4	90 17 11 150 00-93	holder	1.00	20
8	90 14 20 026 00 90	seal	1.00	2