





MEM Concealed two-way diverter - Brushed Durabrand (23kt Gold)
MEM

36 200 782
Product version from 4/1/2022

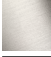
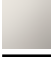

- rotary diverter
- rosette 60 x 60 mm
- with shut-off function

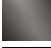
	Brushed Durabrand (23kt Gold)	36 200 782-28 0010
	Chrome	36 200 782-00 0010
	Brushed Platinum	36 200 782-06 0010
	Platinum	36 200 782-08 0010
	Dark Chrome	36 200 782-19 0010
	Brushed Dark Brass	36 200 782-39 0010
	Brushed Dark Platinum	36 200 782-99 0010

Required miscellaneous

	Concealed two-way diverter - •max. recess depth 160 mm •min. recess depth 115 mm	35 202 970-90 0010
---	---	-----------------------

mm [inches]

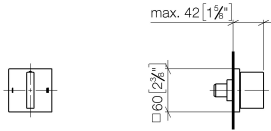

Codes & Standards

ADA	California Energy Commission (CEC)
-----	--

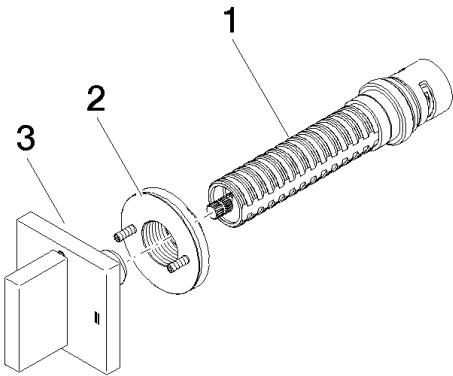

Spare parts list

No.	Item Number	Name	Quantity used	Delivery time
2	90 21 02 181 00 90	disc	1.00	2
3	90 20 78 002 09-28	handle	1.00	20
1	90 90 03 306 10 90	diverter	1.00	2