

CL.1 Concealed two-way diverter - Brushed Champagne (22kt Gold)

36 202 705    Product version from 4/1/2022



- with CASCADE structure
- rotary diverter
- rosette 60 x 60 mm
- with shut-off function

	Brushed Champagne (22kt Gold)	36 202 705-46 0010
	Chrome	36 202 705-00 0010
	Brushed Platinum	36 202 705-06 0010
	Dark Chrome	36 202 705-19 0010
	Champagne (22kt Gold)	36 202 705-47 0010
	Brushed Dark Platinum	36 202 705-99 0010

Required miscellaneous

	Concealed two-way diverter -	35 202 970-90 0010
---	------------------------------	--------------------



# CL.1 Concealed two-way diverter - Brushed Champagne (22kt Gold)

36 202 705    Product version from 4/1/2022

mm [inches]

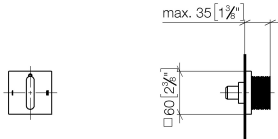

## Flow rate chart

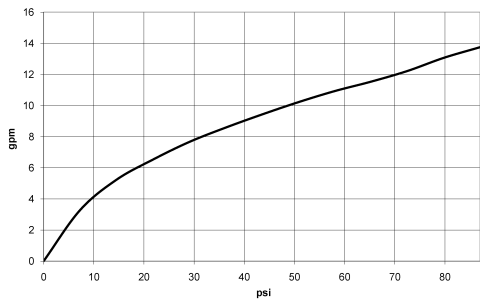

## Codes & Standards

ASME A112.18.1	California Energy Commission (CEC)	cUPC
----------------	------------------------------------	------



## CL.1 Concealed two-way diverter - Brushed Champagne (22kt Gold)

---

36 202 705 Product version from 4/1/2022

### Certificates

---

IAPMO\_4976 (

CL.1 Concealed two-way diverter - Brushed Champagne (22kt Gold)

36 202 705    Product version from 4/1/2022

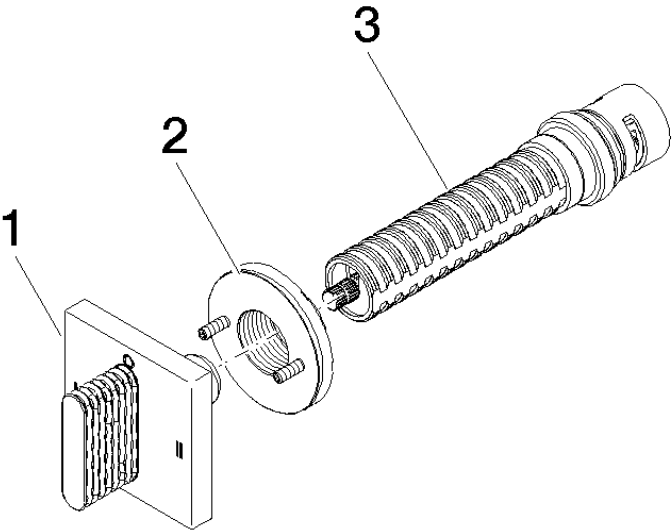

Spare parts list

No.	Item Number	Name	Quantity used	Delivery time
1	90 20 70 053 09-46	handle	1	30
2	90 21 02 181 00 90	disc	1	2
3	90 90 03 306 10 90	diverter	1	2