

META Wall valve clockwise closing 1/2" - Chrome

META

36 310 660

Product version from 4/1/2024

- rosette Ø 60 mm
 - head part with cut-to-length spindle and sleeve



| | | |
|---|-----------------------|---------------|
|  | Chrome | 36 310 660-00 |
|  | Brushed Platinum | 36 310 660-06 |
|  | Platinum | 36 310 660-08 |
|  | Dark Chrome | 36 310 660-19 |
|  | Light Gold | 36 310 660-26 |
|  | Brushed Light Gold | 36 310 660-27 |
|  | Matte Black | 36 310 660-33 |
|  | Brushed Dark Brass | 36 310 660-39 |
|  | Brushed Bronze | 36 310 660-42 |
|  | Brushed Chrome | 36 310 660-93 |
|  | Brushed Dark Platinum | 36 310 660-99 |

Required miscellaneous



- Wall valve clockwise closing 1/2" -

35 621 970-90

 - min. recess depth 65 mm
 - max. recess depth 115 mm

0010

36 310 660 Product version from 4/1/2024

mm [inches]



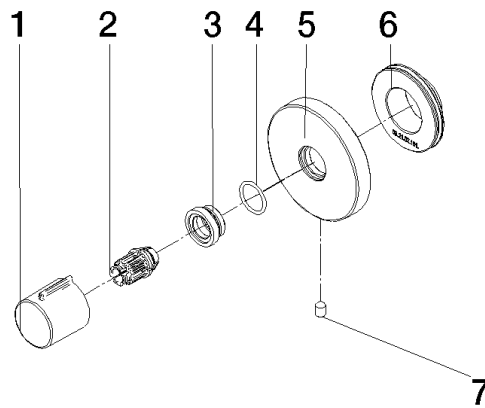

Spare parts list

| No. | Item Number | Name | Quantity used | Delivery time |
|-----|--------------------|------------|---------------|---------------|
| 5 | 90 27 67 021 94-00 | rosette | 1.00 | 10 |
| 2 | 09 12 12 005 90 | fixing cap | 1.00 | 2 |
| 3 | 09 12 12 043-00 | base | 1.00 | 10 |
| 1 | 09 20 98 001-00 | handle | 1.00 | 10 |
| 7 | 09 31 11 004 90 | pin | 1.00 | 60 |
| 6 | 09 21 02 151 90 | sleeve | 1.00 | 2 |
| 4 | 09 14 10 017 90 | seal | 1.00 | 2 |