

META Wall valve clockwise closing 1/2" - Dark Chrome

META

36 310 660

Product version from 4/1/2024

- rosette Ø 60 mm
 - head part with cut-to-length spindle and sleeve



	Dark Chrome	36 310 660-19
	Chrome	36 310 660-00
	Brushed Platinum	36 310 660-06
	Platinum	36 310 660-08
	Light Gold	36 310 660-26
	Brushed Light Gold	36 310 660-27
	Matte Black	36 310 660-33
	Brushed Dark Brass	36 310 660-39
	Brushed Bronze	36 310 660-42
	Brushed Chrome	36 310 660-93
	Brushed Dark Platinum	36 310 660-99

Required miscellaneous



- Wall valve clockwise closing 1/2" -

35 621 970-90

 - min. recess depth 65 mm
 - max. recess depth 115 mm

0010

36 310 660 Product version from 4/1/2024

mm [inches]

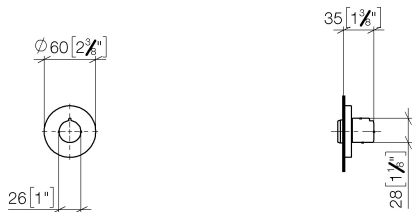

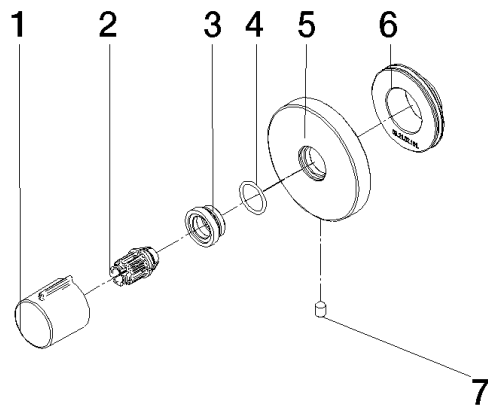

Spare parts list

No.	Item Number	Name	Quantity used	Delivery time
	3 09 12 12 043-19	base	1.00	60
	5 90 27 67 021 94-19	rosette	1.00	20
	2 09 12 12 005 90	fixing cap	1.00	2
	1 09 20 98 001-19	handle	1.00	60
	4 09 14 10 017 90	seal	1.00	2
	7 09 31 11 004 90	pin	1.00	60
	6 09 21 02 151 90	sleeve	1.00	2