









META Wall valve clockwise closing 1/2" - Brushed Chrome

META

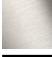
36 310 660    Product version from 4/1/2024



- rosette Ø 60 mm
- head part with cut-to-length spindle and sleeve

	Brushed Chrome	36 310 660-93
	Chrome	36 310 660-00
	Brushed Platinum	36 310 660-06
	Platinum	36 310 660-08
	Dark Chrome	36 310 660-19
	Light Gold	36 310 660-26
	Brushed Light Gold	36 310 660-27
	Matte Black	36 310 660-33
	Brushed Dark Brass	36 310 660-39
	Brushed Bronze	36 310 660-42
	Brushed Dark Platinum	36 310 660-99

Required miscellaneous



- Wall valve clockwise closing 1/2" - 35 621 970-90 0010**
- min. recess depth 65 mm
  - max. recess depth 115 mm

36 310 660 Product version from 4/1/2024

mm [inches]

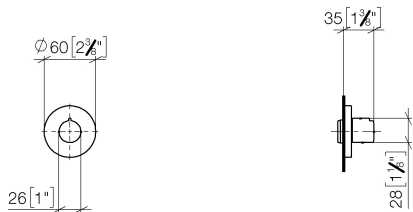

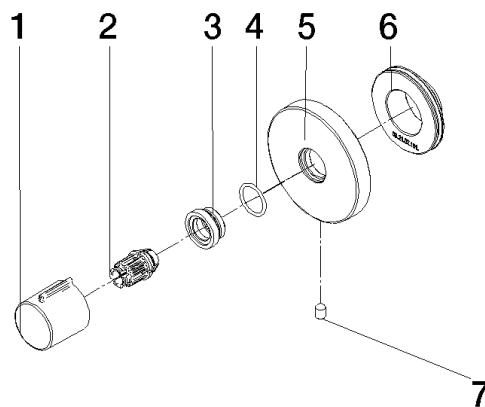

## Spare parts list

No.	Item Number	Name	Quantity used	Delivery time
1	09 20 98 001-93	handle	1.00	20
2	09 12 12 005 90	fixing cap	1.00	2
3	09 12 12 043-93	base	1.00	20
7	09 31 11 004 90	pin	1.00	60
4	09 14 10 017 90	seal	1.00	2
6	09 21 02 151 90	sleeve	1.00	2
5	90 27 67 021 94-93	rosette	1.00	20