

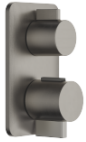





LISSÉ Concealed thermostat with one function volume control - Brushed Dark Platinum

LISSÉ

36 425 845

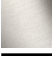

- cover plate 150 x 90 mm
- temperature control handle with safety limit stop at 38°C
- hot water temperature limiter, can be preset

	Brushed Dark Platinum	36 425 845-99 0010
	Chrome	36 425 845-00 0010
	Brushed Platinum	36 425 845-06 0010
	Dark Chrome	36 425 845-19 0010
	Matte Black	36 425 845-33 0010
	Brushed Chrome	36 425 845-93 0010

Required miscellaneous



Concealed thermostat for one- and two-way outlets -

- min. recess depth 80 mm
- max. recess depth 136 mm

35 426 970-90 0010

Recommended miscellaneous



xGRID Attachment set for integrating in the dry wall construction -

12 340 970 90

Required miscellaneous



xGRID Installation track 555 mm - 12 360 970 90



LISSE Concealed thermostat with one function volume control - Brushed Dark Platinum

LISSE

36 425 845
mm [inches]

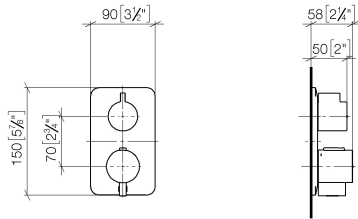

Codes & Standards

ADA

ASME
A112.18.1/CSA
B125.1

LISSÉ Concealed thermostat with one function volume control - Brushed Dark Platinum

LISSÉ

36 425 845

Product version from 6/30/2022

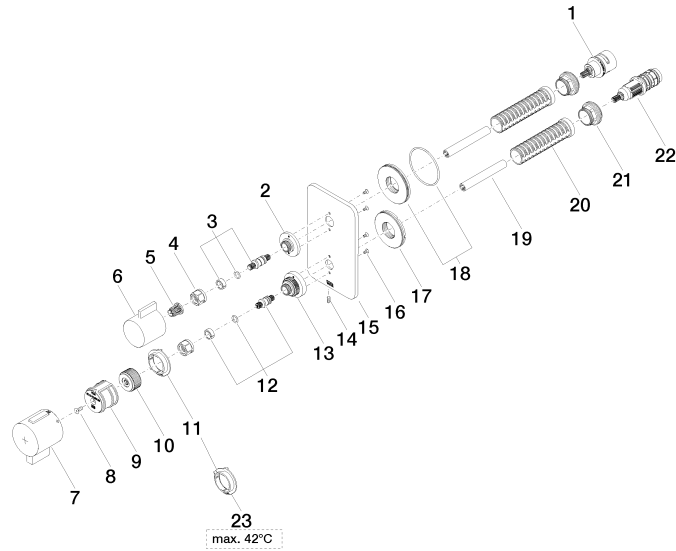



LISSE Concealed thermostat with one function volume control - Brushed Dark
Platinum

LISSE

36 425 845

Spare parts list

Product version from 6/30/2022

No.	Item Number	Name	Quantity used	Delivery time
	90 90 03 166 00 90	top	30	2