



## Concealed thermostat with three function volume control - Brushed Chrome

SERIES SPECIFIC

36 428 670 Product version from 3/13/2017 to 9/26/2018

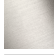

- rotary diverter with volume control and shut-off function
- cover plate 150 x 90 mm
- temperature control handle with safety limit stop at 38°C
- hot water temperature limiter, can be preset
- single flow function only

|   |                                |                    |
|---|--------------------------------|--------------------|
|    | Brushed Chrome                 | 36 428 670-93 0010 |
|    | Chrome                         | 36 428 670-00 0010 |
|    | Brushed Platinum               | 36 428 670-06 0010 |
|    | Platinum                       | 36 428 670-08 0010 |
|    | Dark Chrome                    | 36 428 670-19 0010 |
|    | Brushed Light Gold             | 36 428 670-27 0010 |
|    | Brushed Durabronze (23kt Gold) | 36 428 670-28 0010 |
|    | Matte Black                    | 36 428 670-33 0010 |
|    | Brushed Champagne (22kt Gold)  | 36 428 670-46 0010 |
|   | Champagne (22kt Gold)          | 36 428 670-47 0010 |
|  | Brushed Dark Platinum          | 36 428 670-99 0010 |

Concealed thermostat with three function volume control - Brushed Chrome

SERIES SPECIFIC

36 428 670

Product version from 3/13/2017 to 9/26/2018

mm [inches]

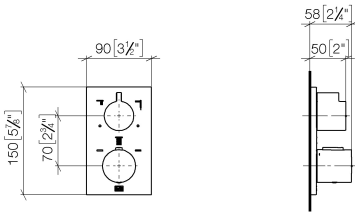

Codes & Standards

|     |                |                                    |      |
|-----|----------------|------------------------------------|------|
| ADA | ASME A112.18.1 | California Energy Commission (CEC) | cUPC |
|-----|----------------|------------------------------------|------|

Certificates and sustainability

IAPMO\_4976 (

36 428 670 Product version from 3/13/2017 to 9/26/2018

Parts for other  
finishes can be found  
here: [Chrome](#)

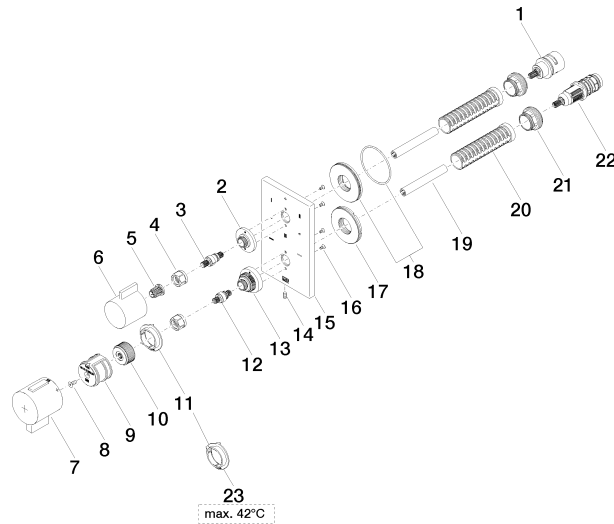



## Concealed thermostat with three function volume control - Brushed Chrome

SERIES SPECIFIC

36 428 670 Product version from 3/13/2017 to 9/26/2018

### Spare parts list

| No. | Item Number        | Name       | Quantity used | Delivery time |
|-----|--------------------|------------|---------------|---------------|
| 14  | 09 31 11 134 90    | pin        | 1.00          | 2             |
| 1   | 90 90 03 170 00 90 | diverter   | 1.00          | 2             |
| 11  | 09 28 10 190 90    | regulator  | 1.00          | 2             |
| 18  | 90 30 01 190 00 90 | disc       | 1.00          | 2             |
| 7   | 90 17 33 019 00-93 | handle     | 1.00          | 20            |
| 22  | 90 15 02 013 00 90 | cartridge  | 1.00          | 2             |
| 5   | 90 12 12 002 00 90 | fixing cap | 1.00          | 2             |
| 16  | 09 30 30 157 90    | screw      | 4.00          | 2             |
| 21  | 09 24 04 257 90    | nut        | 2.00          | 2             |
| 15  | 09 11 02 323-93    | plate      | 1.00          | 20            |
| 17  | 09 30 01 296 90    | disc       | 1.00          | 2             |
| 23  | 09 28 10 189 90    | regulator  | 1.00          | 2             |
| 2   | 09 12 12 053-93    | base       | 1.00          | 20            |
| 10  | 09 12 12 054 90    | base       | 1.00          | 2             |
| 13  | 09 12 12 051-93    | base       | 1.00          | 20            |
| 6   | 09 20 67 006-93    | handle     | 1.00          | 20            |
| 20  | 90 18 40 077 01 90 | spindle    | 2.00          | 2             |
| 12  | 04 29 06 024 01-00 | spindle    | 1.00          | 10            |
| 9   | 90 12 12 052 00 90 | base       | 1.00          | 2             |
| 8   | 90 30 30 124 00 90 | screw      | 1.00          | 2             |
| 19  | 90 23 01 124 00 90 | sleeve     | 2.00          | 2             |
| 4   | 90 23 30 023 00 90 | nut        | 2.00          | 2             |
| 3   | 04 29 06 111 01-00 | spindle    | 1.00          | 10            |