

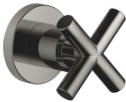





TARA Wall valve clockwise closing 1/2" - Dark Chrome
TARA

36 607 892

- rosette Ø 55 mm
- head part with cut-to-length spindle and sleeve



	Dark Chrome	36 607 892-19
	Chrome	36 607 892-00
	Brushed Platinum	36 607 892-06
	Platinum	36 607 892-08
	Brushed Durabrass (23kt Gold)	36 607 892-28
	Matte Black	36 607 892-33
	Brushed Champagne (22kt Gold)	36 607 892-46
	Champagne (22kt Gold)	36 607 892-47
	Brushed Chrome	36 607 892-93
	Brushed Dark Platinum	36 607 892-99

Required miscellaneous

	Wall valve 1/2" -	35 607 970-90
	•max. recess depth 145 mm	0010
	•min. recess depth 85 mm	

36 607 892

mm [inches]

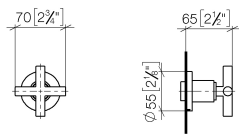

Codes & Standards

ADA	ASME A112.18.1/CSA B125.1
-----	---------------------------------

Certificates

DVGW_DW- 6501DN0116.	WRAS_2011026.	LGA_29931.	WRAS_2010066.	DVGW_DW- 6512DN0706.
-------------------------	---------------	------------	---------------	-------------------------

