







CL.1 Wall valve clockwise closing cold 1/2" - Dark Chrome

CL.1

36 627 706

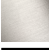

- with CASCADE structure
- rosette 60 x 60 mm
- with cold marking
- head part with cut-to-length spindle and sleeve
- WRAS 2010066

	Dark Chrome	36 627 706-19
	Chrome	36 627 706-00
	Brushed Platinum	36 627 706-06
	Brushed Champagne (22kt Gold)	36 627 706-46
	Champagne (22kt Gold)	36 627 706-47
	Brushed Dark Platinum	36 627 706-99

Required miscellaneous



Wall valve 1/2" -	35 607 970-90
• max. recess depth 150 mm	0010
• min. recess depth 105 mm	



CL.1 Wall valve clockwise closing cold 1/2" - Dark Chrome

CL.1

36 627 706

mm [inches]



Codes & Standards			
ADA	ASME A112.18.1/CSA B125.1	DIN 4109	ISO 3822
Scottish Water Byelaws	UK Water Supply Regulations	Ü-Zeichen	

Certificates	
WRAS_2010	LGA_29

Product version from 10/14/2020

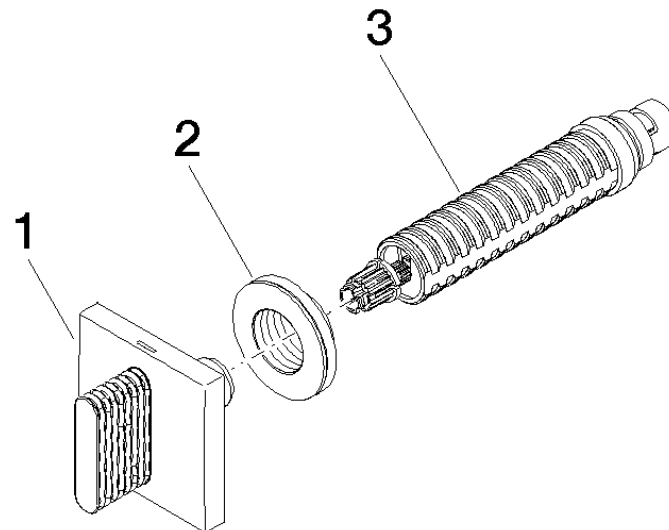



CL.1 Wall valve clockwise closing cold 1/2" - Dark Chrome

CL.1

36 627 706

Spare parts list

Product version from 10/14/2020