

MEM Wall-mounted basin mixer without pop-up waste - Brushed Champagne (22kt Gold)

MEM

36 712 782 Product version from 10/27/2020



- 200mm projection
- fixed spout
- rectangular, air-enriched flow
- hole diameter valve 40 mm
- hole diameter spout 40 mm
- individual rosettes 60 x 60 mm
- max. flow 4.5 l/min
- lead-free
- This product can help a building meet the requirements of Green Building Rating Systems, e.g. LEED®, BREEAM®, DGNB

	Brushed Champagne (22kt Gold)	36 712 782-46 0010
	Chrome	36 712 782-00 0010
	Brushed Platinum	36 712 782-06 0010
	Platinum	36 712 782-08 0010
	Dark Chrome	36 712 782-19 0010
	Brushed Durabronze (23kt Gold)	36 712 782-28 0010
	Champagne (22kt Gold)	36 712 782-47 0010
	Brushed Dark Platinum	36 712 782-99 0010

Required miscellaneous



- Concealed wall-mounted mixer centred spout -** 35 700 970-90 0010
- max. recess depth 150 mm
 - min. recess depth 110 mm

Required miscellaneous



- Concealed wall-mounted mixer variable positioning -** 35 720 970-90 0010
- max. recess depth 150 mm
 - min. recess depth 110 mm



MEM Wall-mounted basin mixer without pop-up waste - Brushed Champagne
(22kt Gold)

MEM

36 712 782 Product version from 10/27/2020
mm [inches]

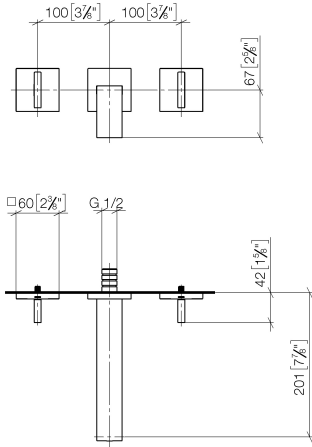

Codes & Standards

ADA	ASME A112.18.1	California Energy Commission (CEC)	cUPC
EPA WaterSense	NSF372	NSF61	WaterSense



Certificates and sustainability

IAPMO_N-4976	IAPMO_6397	IAPMO_4976 (IAPMO_8834
--------------	------------	--------------	------------

MEM Wall-mounted basin mixer without pop-up waste - Brushed Champagne (22kt Gold)

MEM

36 712 782 Product version from 10/27/2020

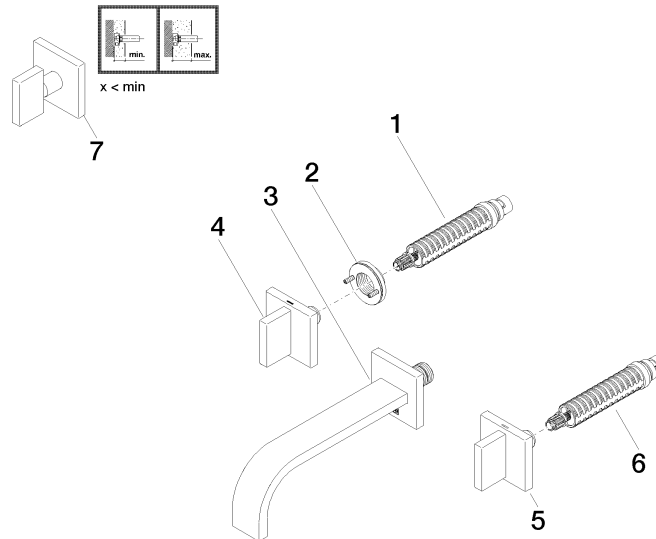

Spare parts list

No.	Item Number	Name	Quantity used	Delivery time
1	90 90 03 156 00 90	top	1.00	2
5	90 20 78 002 06-46	handle (cold)	1.00	30
6	90 90 03 157 00 90	top	1.00	2
2	90 21 02 108 00 90	disc	1.00	2
4	90 20 78 002 07-46	handle (hot)	1.00	30
3	13 800 782-46 0010	MEM Wall-mounted basin spout without pop-up waste - Brushed Champagne (22kt Gold)	1.00	-
Spare part can no longer be ordered, please order the replacement item				
7	90 20 78 002 01-46	handle	1.00	30