

## VAIA Washstand fitting with electronic opening and closing function without pop-up waste - Matte Black

VAIA

44 521 809 Product version from 4/1/2025



- Infrared sensor technology
- 167mm projection
- height of mixer 306 mm
- height up to aerator 221 mm
- hole diameter 35 mm
- fixed spout
- max. flow 1.9 l/min
- laminar flow
- suitable for thermal disinfection
- Automatic shut-off after pre-set time is reached
- Indirect temperature control (undercounter)
- Control box included
- Adjustable sensor detection range
- Battery or plug-in power supply operated (batteries not included)
- 4x AA (1.5V) batteries required
- lead-free
- 1x screw-in M 8 x 1 pressure hose, leak-tested
- This product can help a building meet the requirements of Green Building Rating Systems, e.g. LEED®, BREEAM®, DGNB

Batteries not included

Caution: A temperature stabiliser is recommended for installations in public areas. Please observe your local building codes.

|   |                                |                    |
|---|--------------------------------|--------------------|
|    | Matte Black                    | 44 521 809-33 0010 |
|    | Chrome                         | 44 521 809-00 0010 |
|    | Brushed Platinum               | 44 521 809-06 0010 |
|    | Platinum                       | 44 521 809-08 0010 |
|    | Dark Chrome                    | 44 521 809-19 0010 |
|    | Brushed Durabronze (23kt Gold) | 44 521 809-28 0010 |
|    | Brushed Dark Brass             | 44 521 809-39 0010 |
|    | Brushed Bronze                 | 44 521 809-42 0010 |
|    | Brushed Champagne (22kt Gold)  | 44 521 809-46 0010 |
|   | Champagne (22kt Gold)          | 44 521 809-47 0010 |
|  | Brushed Chrome                 | 44 521 809-93 0010 |
|  | Brushed Dark Platinum          | 44 521 809-99 0010 |

VAIA Washstand fitting with electronic opening and closing function without pop-up waste - Matte Black

VAIA

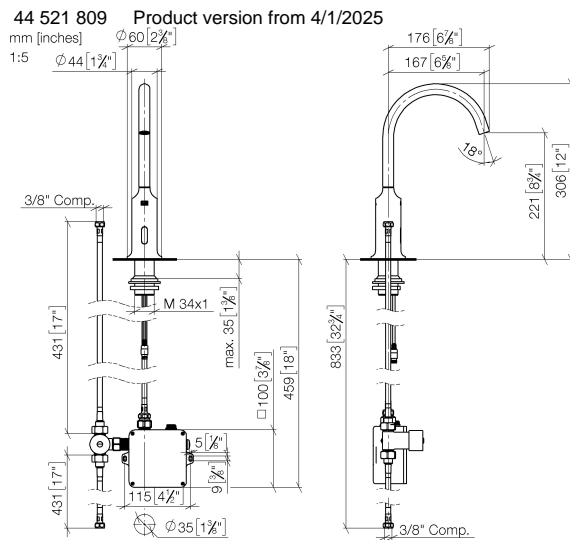

## Codes & Standards

|                |                                    |      |        |
|----------------|------------------------------------|------|--------|
| ASME A112.18.1 | California Energy Commission (CEC) | cUPC | NSF372 |
|----------------|------------------------------------|------|--------|

## Certificates and sustainability

IAPMO\_6397 IAPMO\_4976 (

## VAIA Washstand fitting with electronic opening and closing function without pop-up waste - Matte Black

VAIA

44 521 809 Product version from 4/1/2025

Parts for other  
finishes can be found  
here: [Chrome](#)

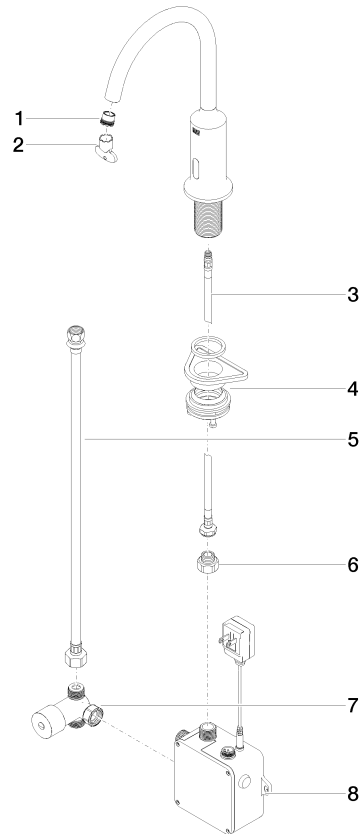

### Spare parts list

| No. | Item Number        | Name                  | Quantity used | Delivery time |
|-----|--------------------|-----------------------|---------------|---------------|
| 4   | 04 23 10 044 08 90 | fixing set            | 1.00          | 2             |
| 6   | 09 24 03 185-00    | nipple                | 1.00          | 10            |
| 1   | 09 29 03 094 90    | aerator               | 1.00          | 2             |
| 5   | 12 506 970 90      | High pressure hoses - | 1.00          | 2             |
| 7   | 90 30 50 081 00 90 | valve                 | 1.00          | 2             |
| 8   | 90 10 01 247 02 90 | valve box             | 1.00          | 60            |
| 3   | 04 30 04 100 00 90 | hose                  | 1.00          | 2             |
| 2   | 90 30 09 028 00 90 | key                   | 1.00          | 2             |