







CL.1 Wall-mounted basin mixer without pop-up waste - Brushed Champagne (22kt Gold)

CL.1

<div>ST 010 201 0705</div> <div>  </div>	<ul style="list-style-type: none"> <li>• 200mm projection</li> <li>• fixed spout</li> <li>• rectangular spray pattern with 40 individual jets</li> <li>• hole diameter valve 35 mm</li> <li>• hole diameter spout 40 mm</li> <li>• rosette 60 x 60 mm</li> <li>• max. flow 4.5 l/min</li> <li>• lead-free</li> <li>• This product can help a building meet the requirements of Green Building Rating Systems, e.g. LEED®, BREEAM®, DGNB</li> </ul>	<div>            Brushed Champagne (22kt Gold)         </div> <div>ST 010 201 0705-46</div>
		<div>            Chrome         </div> <div>ST 010 201 0705-00</div>
		<div>            Brushed Platinum         </div> <div>ST 010 201 0705-06</div>
		<div>            Dark Chrome         </div> <div>ST 010 201 0705-19</div>
		<div>            Champagne (22kt Gold)         </div> <div>ST 010 201 0705-47</div>
		<div>            Brushed Dark Platinum         </div> <div>ST 010 201 0705-99</div>

Individual components of this set

You need the following components for this set

<div>1x</div> <div>  </div> <div>13 800 705-46</div>	<div>1x</div> <div>  </div> <div>36 607 706-46</div>
<div>1x</div> <div>  </div> <div>36 607 707-46</div>	





CL.1 Wall-mounted basin mixer without pop-up waste - Brushed Champagne (22kt Gold)

CL.1

ST 010 201 0705

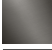

- 200mm projection
- fixed spout
- rectangular spray pattern with 40 individual jets
- hole diameter 37 mm
- lead-free
- 1/2" connection
- plug-link mounting
- max. flow 4.5 l/min
- This product can help a building meet the requirements of Green Building Rating Systems, e.g. LEED®, BREEAM®, DGNB
- WRAS 1512013

	Brushed Champagne (22kt Gold)	13 800 705-4
	Chrome	13 800 705-0
	Brushed Platinum	13 800 705-0
	Dark Chrome	13 800 705-1
	Champagne (22kt Gold)	13 800 705-4
	Brushed Dark Platinum	13 800 705-9



CL.1 Wall-mounted basin mixer without pop-up waste - Brushed Champagne  
(22kt Gold)

---

CL.1

ST 010 201 0705

6  
—  
10  
—  
16  
—  
9  
—  
.7  
—  
19  
—

# CL.1 Wall-mounted basin mixer without pop-up waste - Brushed Champagne (22kt Gold)

CL.1

ST 010 201 0705  
mm [inches]

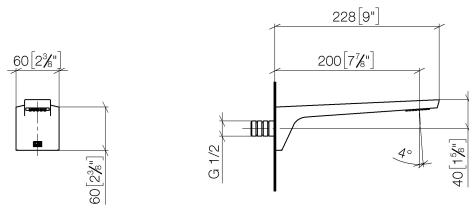

Flow rate chart

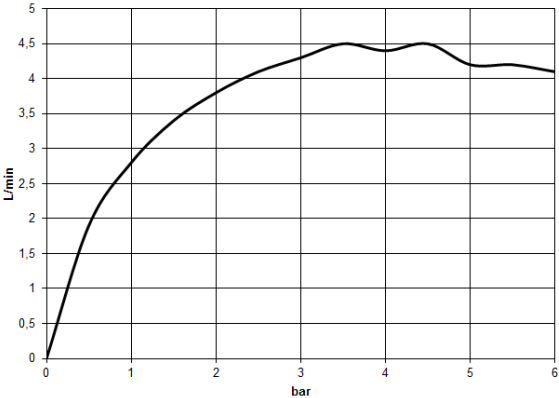

## Certificates

IAPMO\_N-4

IAPMO\_6



CL.1 Wall-mounted basin mixer without pop-up waste - Brushed Champagne  
(22kt Gold)

CL.1

ST 010 201 0705

Codes & Standards

ASME	California Energy	NSF/ANSI 372	NSF/ANSI/CAN
A112.18.1/CSA	Commission		61
B125.1	(CEC)		
NSF372	NSF61		



## CL.1 Wall-mounted basin mixer without pop-up waste - Brushed Champagne (22kt Gold)

---

CL.1

ST 010 201 0705

# CL.1 Wall-mounted basin mixer without pop-up waste - Brushed Champagne (22kt Gold)

CL.1

ST 010 201 0705

**Product version from 3/9/2015**

Parts for other  
finishes can be found  
here: [Chrome](#)

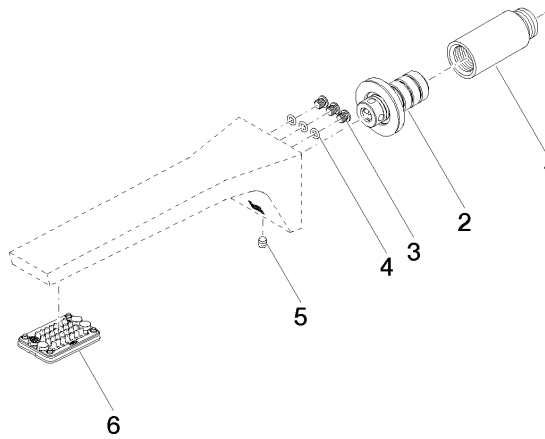



CL.1 Wall-mounted basin mixer without pop-up waste - Brushed Champagne  
(22kt Gold)

CL.1

ST 010 201 0705

Spare parts list

Product version from 3/9/2015

No.	Item Number	Name	Quantity used	Delivery time
	09 24 03 081 10 90	extension	10	2



CL.1 Wall-mounted basin mixer without pop-up waste - Brushed Champagne (22kt Gold)

CL.1

ST 010 201 0705



- rosette 60 x 60 mm
- with cold marking
- head part with cut-to-length spindle and sleeve
- WRAS 2010066

	Brushed Champagne (22kt Gold)	36 607 706-4
	Chrome	36 607 706-0
	Brushed Platinum	36 607 706-0
	Dark Chrome	36 607 706-1
	Champagne (22kt Gold)	36 607 706-4
	Brushed Dark Platinum	36 607 706-9



CL.1 Wall-mounted basin mixer without pop-up waste - Brushed Champagne  
(22kt Gold)

CL.1

ST 010 201 0705

6  
—  
10  
—  
16  
—  
9  
—  
.7  
—  
19  
—

Required miscellaneous



<b>Wall valve 1/2" -</b>	35 607 970-90
•max. recess depth 150 mm	0010
•min. recess depth 105 mm	

CL.1 Wall-mounted basin mixer without pop-up waste - Brushed Champagne  
(22kt Gold)

---

CL.1

ST 010 201 0705  
mm [inches]

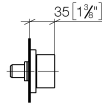

Certificates

---

WRAS\_2010

LGA\_29



CL.1 Wall-mounted basin mixer without pop-up waste - Brushed Champagne  
(22kt Gold)

CL.1

ST 010 201 0705

Codes & Standards

ADA	ASME A112.18.1/CSA B125.1	DIN 4109	ISO 3822
Scottish Water Byelaws	UK Water Supply Regulations	Ü-Zeichen	

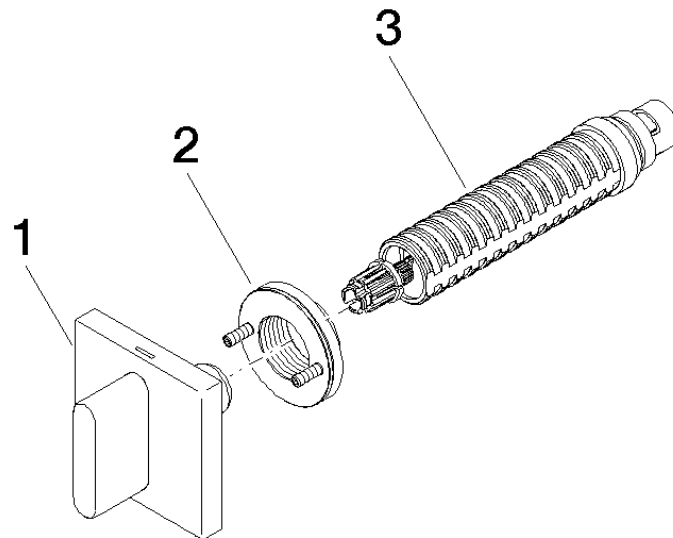



CL.1 Wall-mounted basin mixer without pop-up waste - Brushed Champagne  
(22kt Gold)

CL.1

ST 010 201 0705

**Spare parts list**  
**Product version from 10/14/2020**

No.	Item Number	Name	Quantity used	Delivery time
	90 20 70 051 02-46	handle ( cold )	3	30





# CL.1 Wall-mounted basin mixer without pop-up waste - Brushed Champagne (22kt Gold)

CL.1

ST 010 201 0705

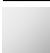

- rosette 60 x 60 mm
- with hot marking
- head part with cut-to-length spindle and sleeve
- WRAS 2010066

	Brushed Champagne (22kt Gold)	36 607 707-4
	Chrome	36 607 707-0
	Brushed Platinum	36 607 707-0
	Dark Chrome	36 607 707-1
	Champagne (22kt Gold)	36 607 707-4
	Brushed Dark Platinum	36 607 707-9

CL.1 Wall-mounted basin mixer without pop-up waste - Brushed Champagne  
(22kt Gold)

---

CL.1

ST 010 201 0705

6  
—  
10  
—  
16  
—  
9  
—  
.7  
—  
19  
—



CL.1 Wall-mounted basin mixer without pop-up waste - Brushed Champagne  
(22kt Gold)

---

CL.1

ST 010 201 0705  
mm [inches]

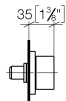
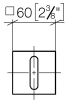

Certificates

---

WRAS\_2010

LGA\_29

Codes & Standards

ADA	ASME A112.18.1/CSA B125.1	DIN 4109	ISO 3822
Scottish Water Byelaws	UK Water Supply Regulations	Ü-Zeichen	

ST 010 201 0705

**Product version from 10/14/2020**

Parts for other  
finishes can be found  
here: Chrome

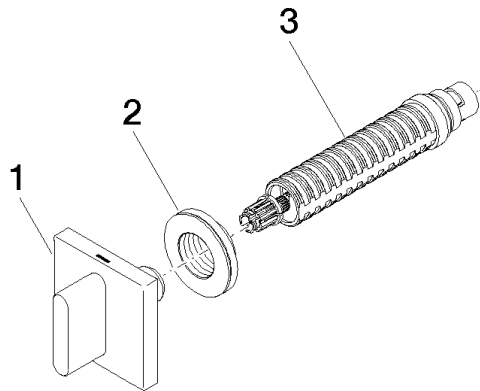

**Spare parts list**

**Product version from 10/14/2020**