

CL.1 Wall-mounted basin mixer without pop-up waste - Champagne (22kt Gold)CL.1

ST 010 201 0705



- 200mm projection
- fixed spout
- rectangular spray pattern with 40 individual jets
- hole diameter valve 35 mm
- hole diameter spout 40 mm
- rosette 60 x 60 mm
- max. flow 4.5 l/min
- lead-free
- This product can help a building meet the requirements of Green Building Rating Systems, e.g. LEED®, BREEAM®, DGNB

	Champagne (22kt Gold)	ST 010 201 0705-47
	Chrome	ST 010 201 0705-00
	Brushed Platinum	ST 010 201 0705-06
	Dark Chrome	ST 010 201 0705-19
	Brushed Champagne (22kt Gold)	ST 010 201 0705-46
	Brushed Dark Platinum	ST 010 201 0705-99

Individual components of this set

You need the following components for this set







1x	13 800 705-47	1x	36 607 706-47
1x	36 607 707-47		

CL.1 Wall-mounted basin mixer without pop-up waste - Champagne (22kt Gold)CL.1

ST 010 201 0705

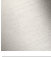

- 200mm projection
- fixed spout
- rectangular spray pattern with 40 individual jets
- hole diameter 37 mm
- lead-free
- 1/2" connection
- plug-link mounting
- max. flow 4.5 l/min
- This product can help a building meet the requirements of Green Building Rating Systems, e.g. LEED®, BREEAM®, DGNB
- WRAS 1512013

	Champagne (22kt Gold)	13 800 705-4
	Chrome	13 800 705-0
	Brushed Platinum	13 800 705-0
	Dark Chrome	13 800 705-1
	Brushed Champagne (22kt Gold)	13 800 705-4
	Brushed Dark Platinum	13 800 705-9



CL.1 Wall-mounted basin mixer without pop-up waste - Champagne (22kt Gold)

CL.1

ST 010 201 0705

.7
—
0
—
6
—
9
—
6
—
9
—

ST 010 201 0705

mm [inches]

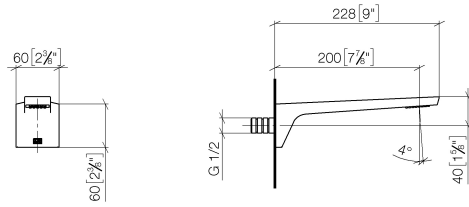

Flow rate chart

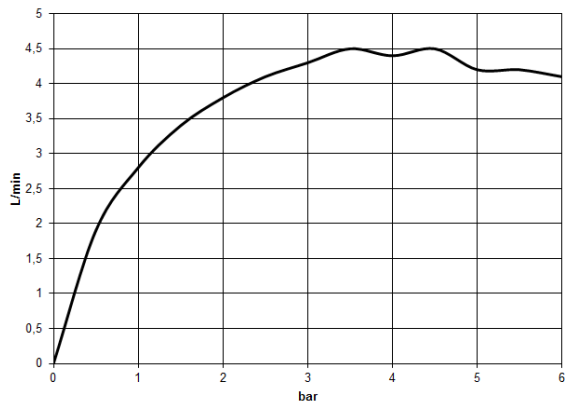

Certificates

IAPMO_N-4

IAPMO_8834

IAPMO_6



CL.1 Wall-mounted basin mixer without pop-up waste - Champagne (22kt Gold)

CL.1

ST 010 201 0705

Codes & Standards

ASME A112.18.1/CSA B125.1	California Energy Commission (CEC)	EPA WaterSense	NSF/ANSI 372
NSF/ANSI/CAN 61	NSF372	NSF61	Water Sense
WaterSense			

Product version from 3/9/2015

Parts for other
finishes can be found
here: [Chrome](#)

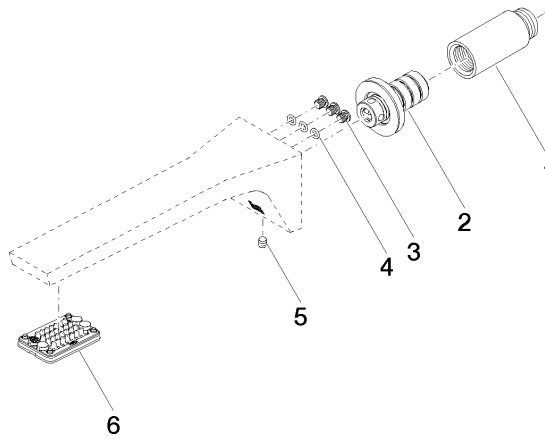



CL.1 Wall-mounted basin mixer without pop-up waste - Champagne (22kt Gold)

CL.1

ST 010 201 0705

Spare parts list

Product version from 3/9/2015







No.	Item Number	Name	Quantity used	Delivery time
	09 24 03 081 10 90	extension	10	2

CL.1 Wall-mounted basin mixer without pop-up waste - Champagne (22kt Gold)CL.1

ST 010 201 0705

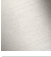

- rosette 60 x 60 mm
- with cold marking
- head part with cut-to-length spindle and sleeve
- WRAS 2010066

	Champagne (22kt Gold)	36 607 706-4
	Chrome	36 607 706-0
	Brushed Platinum	36 607 706-0
	Dark Chrome	36 607 706-1
	Brushed Champagne (22kt Gold)	36 607 706-4
	Brushed Dark Platinum	36 607 706-9

ST 010 201 0705

.7
—
0
—
6
—
9
—
6
—
9
—

Required miscellaneous

	Wall valve 1/2" -	35 607 970-90
	•max. recess depth 150 mm	0010
	•min. recess depth 105 mm	

CL.1 Wall-mounted basin mixer without pop-up waste - Champagne (22kt Gold) CL.1

ST 010 201 0705

mm [inches]



Certificates

WRAS_2010 LGA_29

Codes & Standards			
ADA	ASME A112.18.1/CSA B125.1	DIN 4109	ISO 3822
Scottish Water Byelaws	UK Water Supply Regulations	Ü-Zeichen	

Product version from 10/14/2020

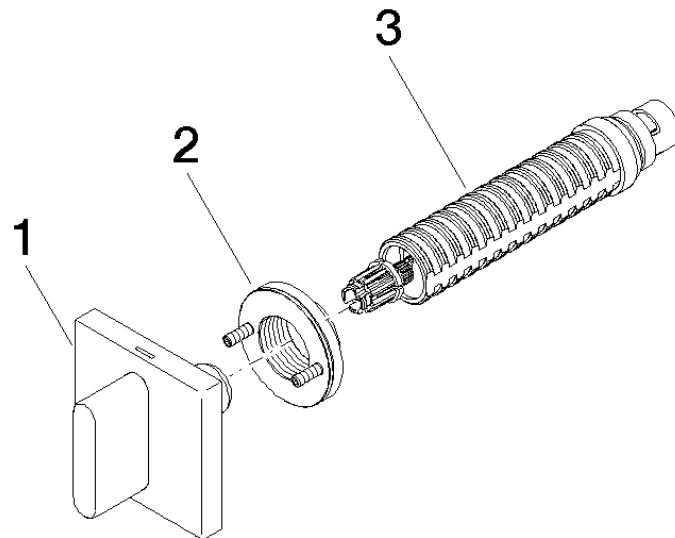

ST 010 201 0705

Spare parts list

Product version from 10/14/2020

No.	Item Number	Name	Quantity used	Delivery time
	90 20 70 051 02-47	handle (cold)	3	30

CL.1 Wall-mounted basin mixer without pop-up waste - Champagne (22kt Gold)CL.1

ST 010 201 0705



- rosette 60 x 60 mm
- with hot marking
- head part with cut-to-length spindle and sleeve
- WRAS 2010066

	Champagne (22kt Gold)	36 607 707-4
	Chrome	36 607 707-0
	Brushed Platinum	36 607 707-0
	Dark Chrome	36 607 707-1
	Brushed Champagne (22kt Gold)	36 607 707-4
	Brushed Dark Platinum	36 607 707-9



CL.1 Wall-mounted basin mixer without pop-up waste - Champagne (22kt Gold)

CL.1

ST 010 201 0705

.7
—
0
—
6
—
9
—
6
—
9
—

ST 010 201 0705

mm [inches]



Certificates

WRAS_2010 LGA_29

Codes & Standards

ADA	ASME A112.18.1/CSA B125.1	DIN 4109	ISO 3822
Scottish Water Byelaws	UK Water Supply Regulations	Ü-Zeichen	

Product version from 10/14/2020

Parts for other
finishes can be found
here: Chrome

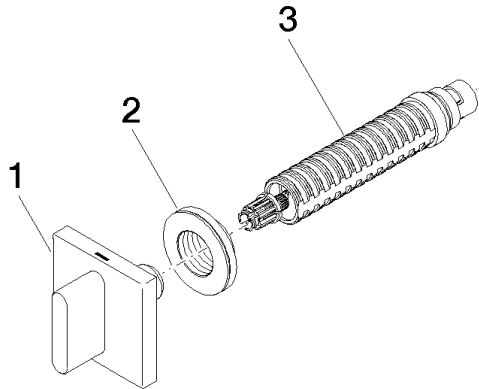

Spare parts list

Product version from 10/14/2020