

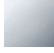



20 700 370



- 135mm projection
- 1 1/4" pop-up waste
- fixed spout
- circular, air-enriched flow
- height of mixer 72 mm
- height up to aerator 40 mm
- hole diameter valve 32 mm
- hole diameter spout 35 mm
- without rosette
- 2x 1/2" x 1/2" high pressure hose
- max. flow 4.5 l/min
- lead-free
- This product can help a building meet the requirements of Green Building Rating Systems, e.g. LEED®, BREEAM®, DGNB

	Durabross (23kt Gold)	20 700 370-09 0010
	Chrome	20 700 370-00 0010
	Brushed Platinum	20 700 370-06 0010
	Platinum	20 700 370-08 0010
	Brushed Durabross (23kt Gold)	20 700 370-28 0010
	Brushed Dark Platinum	20 700 370-99 0010

20 700 370

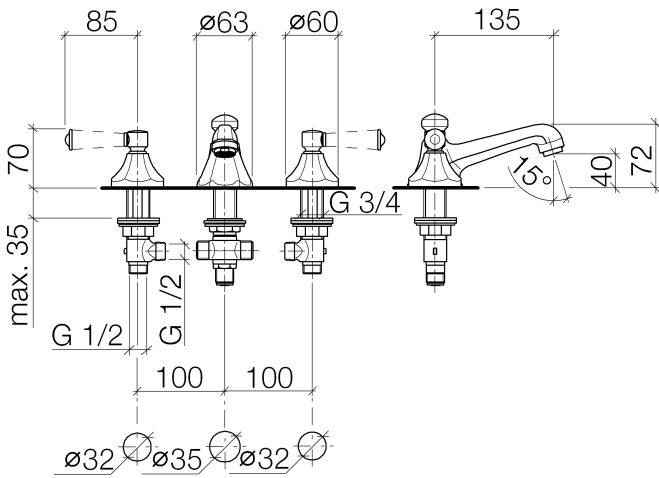

**Flow rate chart**

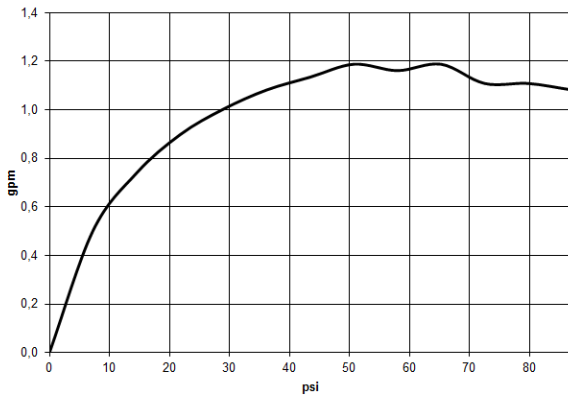

**Codes & Standards**

ADA

ASME  
A112.18.1/CSA  
B125.1

California Energy  
Commission  
(CEC)

NSF/ANSI 372

NSF/ANSI/CAN  
61



MADISON Three-hole basin mixer with pop-up waste - Durabronz (23kt Gold)

---

MADISON

20 700 370

Certificates

---

IAPMO\_N-4976. IAPMO\_4976 (6). IAPMO\_6397.

20 700 370

Parts for other finishes can be found here: [Chrome](#)

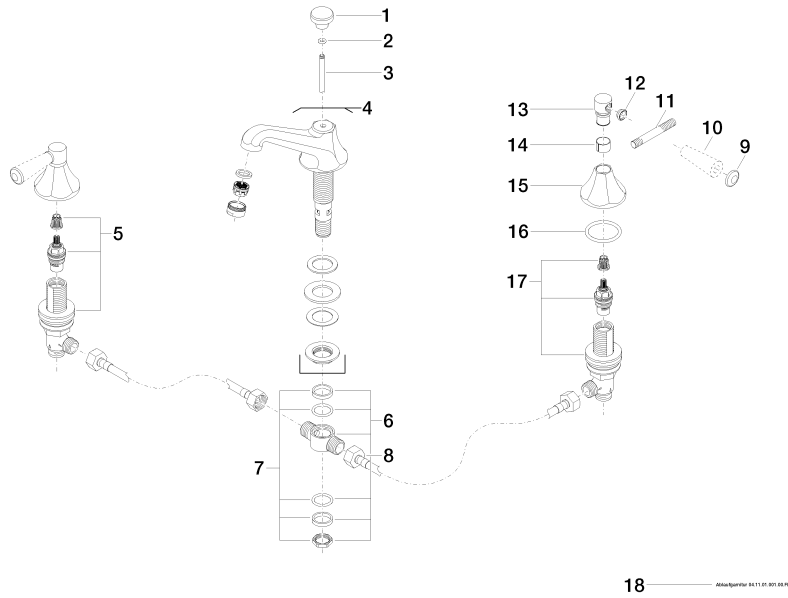

### Spare parts list

No.	Item Number	Name	Quantity used	Delivery time
1	09 20 36 030-09	handle	1	40
2	90 14 10 062 00 90	seal	1	2
3	09 31 09 004-09	pull-rod	1	40
4	13 700 380-09 0010	spout	1	-
Spare part can no longer be ordered, please order the replacement item				
5	90 17 11 040 51 90	side panel	1	2
6	90 17 11 020 10 90	distributor	1	2
7	90 23 10 012 00 90	gasket kit	1	2
8	04 30 04 096 00 90	hose	2	2
9	09 30 30 062-09	screw	2	40
10	11 170 370-09	MADISON Lever insert - Durabronz (23kt Gold)	2	40
11	09 28 22 013 90	pipe	2	2
12	09 20 37 001-09	handle	2	40
13	09 20 82 000-09	handle	2	40
14	90 18 40 041 00 90	sleeve	2	2
15	09 27 37 014-09	rosette	2	40
16	90 14 10 043 00 90	seal	2	2
17	90 17 11 040 50 90	side panel	1	2
18	90 11 01 001 00-09	pop-up waste	1	40