

## VAIA Shower set without hand shower - Chrome

VAIA

26 413 809



- slide bar
- rosette Ø 60 mm
- gauge 800 mm
- metal shower hose 1700mm with integrated anti-twist protection
- shower hose connector 3/8"
- Pipe diameter 18 mm
- WRAS

This article does not include a hand shower!

NOTE: Hand shower sold separately. Please see hand shower options under the miscellaneous articles section of each series.

	Chrome	26 413 809-00
	Brushed Platinum	26 413 809-06
	Platinum	26 413 809-08
	Dark Chrome	26 413 809-19
	Brushed Durabronze (23kt Gold)	26 413 809-28
	Brushed Bronze	26 413 809-42
	Brushed Champagne (22kt Gold)	26 413 809-46
	Champagne (22kt Gold)	26 413 809-47
	Brushed Dark Platinum	26 413 809-99

### Recommended miscellaneous

	<b>Concealed adapter -</b>	35 080 970-90 0010
--	----------------------------	-----------------------

### Recommended miscellaneous

	<b>VAIA Wall elbow - Chrome</b>	28 450 809-00
--	---------------------------------	---------------

### Required miscellaneous

	<b>Hand shower FlowReduce - Chrome</b>	28 016 979-00 0010
--	--	-----------------------

### Required miscellaneous

	<b>Hand shower FlowReduce - Chrome</b>	28 018 979-00 0010
--	--	-----------------------

### Required miscellaneous

	<b>SERIES-VARIOUS Hand shower FlowReduce - Chrome</b>	28 027 979-00 0010
--	---	-----------------------

### Recommended miscellaneous

	<b>Concealed adapter -</b>	35 080 970-90 0010
--	----------------------------	-----------------------

### Required miscellaneous

	<b>Hand shower FlowReduce - Chrome</b>	28 012 979-00 0010
--	--	-----------------------

### Recommended miscellaneous

	<b>VAIA Wall elbow - Chrome</b>	28 450 809-00
--	---------------------------------	---------------

### Required miscellaneous

	<b>SERIES-VARIOUS Hand shower FlowReduce - Chrome</b>	28 025 979-00 0010
--	---	-----------------------

VAIA Shower set without hand shower - Chrome

VAIA

26 413 809

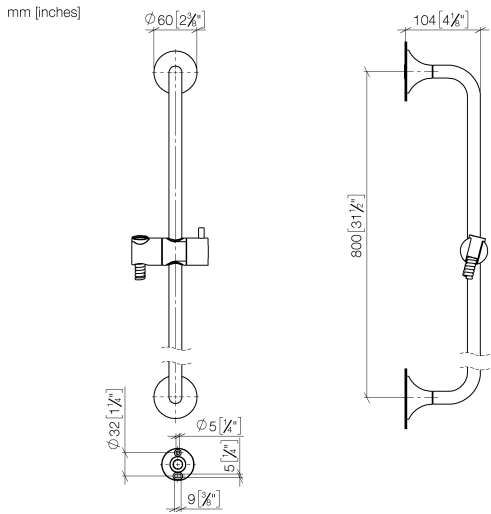

Codes & Standards			
ASME A112.18.1	cUPC	Scottish Water Byelaws	UK Water Supply Regulations
XP P 41-280			

Certificates and sustainability		
WRAS_2009	ACS_20 ACC LY	IAPMO_4976

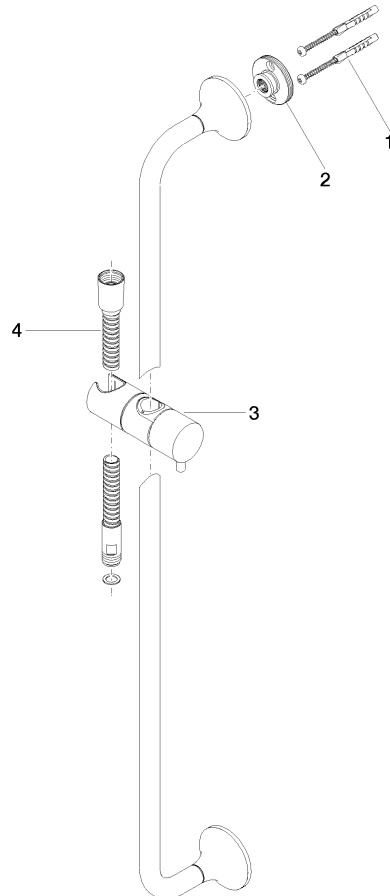

## Spare parts list

No.	Item Number	Name	Quantity used	Delivery time
3	12 580 970-00	Slide unit - Chrome	1.00	10
1	05 30 31 025 00 90	fixing set	2.00	2
2	90 17 20 759 00 90	disc	2.00	2
4	28 322 970-00	Metal shower hose 1/2" x 3/8" x 1750 mm - Chrome	1.00	2