

VAIA Shower set without hand shower - Brushed Platinum

VAIA

26 413 809 Product version from 4/1/2025



- shower hose connector 3/8"
- metal shower hose 1700mm with integrated anti-twist protection
- slide bar

Technical data:

- gauge 800 mm
- rosette Ø 60 mm
- Pipe diameter 18 mm

Notes:

- WRAS

This article does not include a hand shower!

NOTE: Hand shower sold separately. Please see hand shower options under the miscellaneous articles section of each series.

	Brushed Platinum	26 413 809-06
	Chrome	26 413 809-00
	Platinum	26 413 809-08
	Dark Chrome	26 413 809-19
	Brushed Durabronze (23kt Gold)	26 413 809-28
	Brushed Dark Brass	26 413 809-39
	Brushed Bronze	26 413 809-42
	Brushed brass (PVD)	26 413 809-43
	Brushed Champagne (22kt Gold)	26 413 809-46
	Champagne (22kt Gold)	26 413 809-47
	Brushed Dark Platinum	26 413 809-99

Recommended miscellaneous

	Concealed adapter -	35 080 970-90 0010
---	----------------------------	--------------------

Recommended miscellaneous

	VAIA Wall elbow - Brushed Platinum	28 450 809-06
---	---	---------------

Required miscellaneous

	Hand shower FlowReduce - Brushed Platinum	28 016 979-06 0010
---	--	--------------------

Required miscellaneous

	Hand shower FlowReduce - Brushed Platinum	28 018 979-06 0010
---	--	--------------------

Required miscellaneous

	SERIES-VARIOUS Hand shower FlowReduce - Brushed Platinum	28 027 979-06 0010
---	---	--------------------

Recommended miscellaneous

	Concealed adapter -	35 080 970-90 0010
---	----------------------------	--------------------

Required miscellaneous

	Hand shower FlowReduce - Brushed Platinum	28 012 979-06 0010
---	--	--------------------

Recommended miscellaneous

	VAIA Wall elbow - Brushed Platinum	28 450 809-06
---	---	---------------

Required miscellaneous

	SERIES-VARIOUS Hand shower FlowReduce - Brushed Platinum	28 025 979-06 0010
---	---	--------------------

26 413 809 Product version from 4/1/2025

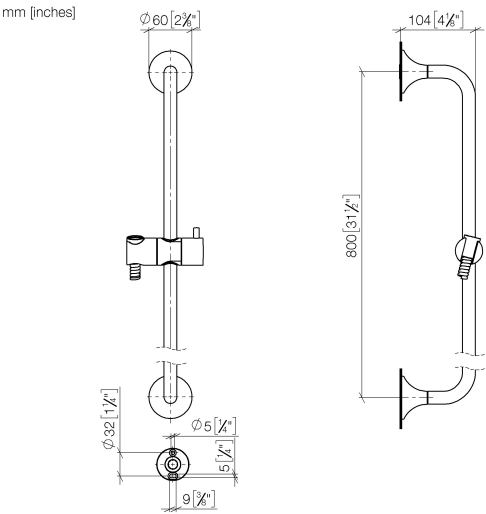

Codes & Standards

ASME A112.18.1	cUPC	Scottish Water Byelaws	UK Water Supply Regulations
XP P 41-280			

Certificates and sustainability

WRAS_2009	ACS_20 ACC LY	IAPMO_4976
-----------	---------------	------------

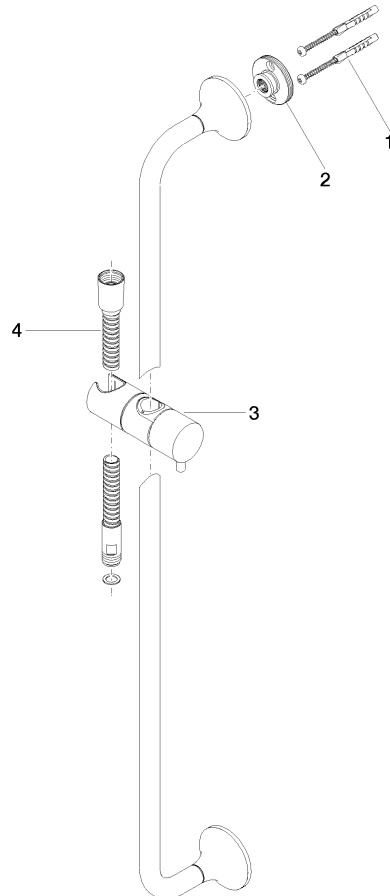

Spare parts list

No.	Item Number	Name	Quantity used	Delivery time
4	28 322 970-06	Metal shower hose 1/2" x 3/8" x 1750 mm - Brushed Platinum	1.00	2
2	90 17 20 759 00 90	disc	2.00	2
3	12 580 970-06	Slide unit - Brushed Platinum	1.00	50
1	05 30 31 025 00 90	fixing set	2.00	2