

TARA Bath shower set for bath rim or tile edge installation - Brushed Dark Platinum

TARA

27 512 882 Product version from 4/1/2024



- spout: circular, air-enriched flow
- max. flow 23.5 l/min at 3 bar flow pressure
- Hand shower: COMPACT RAIN, max. flow rate 6.8 l/min (at 3 bar)
- complete hand shower set with anti-scale system
- 220mm projection
- with anti-scale system
- automatic bath/shower diverter
- height of mixer 290 mm
- height up to aerator 135 mm
- hole diameter valve 32 mm
- hole diameter spout 32 mm
- hole diameter for complete hand shower set 32 mm
- rosette for spout Ø 55mm
- rosette for complete hand shower set Ø 50mm
- rosette for deck valve Ø 55mm
- metal shower hose 1750mm with integrated anti-twist protection

Note: Local building codes may require the use of an anti-scald device. Please refer to remote pressure balance valve (35 910 970 90)

Available with 260 mm or 300 mm projection on request (x-TRA SERVICE).

Intrinsic protection against back flow.

	Brushed Dark Platinum	27 512 882-99
	Chrome	27 512 882-00
	Brushed Platinum	27 512 882-06
	Platinum	27 512 882-08
	Dark Chrome	27 512 882-19
	Brushed Durabronze (23kt Gold)	27 512 882-28
	Matte Black	27 512 882-33
	Brushed Dark Brass	27 512 882-39
	Brushed Bronze	27 512 882-42
	Brushed Champagne (22kt Gold)	27 512 882-46
	Champagne (22kt Gold)	27 512 882-47
	Brushed Chrome	27 512 882-93

TARA Bath shower set for bath rim or tile edge installation - Brushed Dark Platinum

TARA

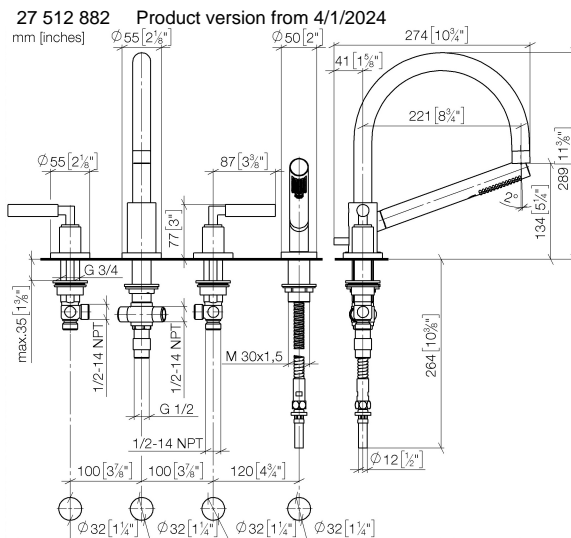

Flow rate chart



Codes & Standards

ADA

ASME A112.18.1

cUPC

DIN 4109

EN 1717

ISO 3822

Ü-Zeichen



TARA Bath shower set for bath rim or tile edge installation - Brushed Dark
Platinum

TARA

27 512 882 Product version from 4/1/2024

Certificates and sustainability

IAPMO_4976	LGA_18	Belgaqua_21-026-2
------------	--------	-------------------

TARA Bath shower set for bath rim or tile edge installation - Brushed Dark Platinum

TARA

27 512 882 Product version from 4/1/2024

Parts for other
finishes can be found
here: [Chrome](#)

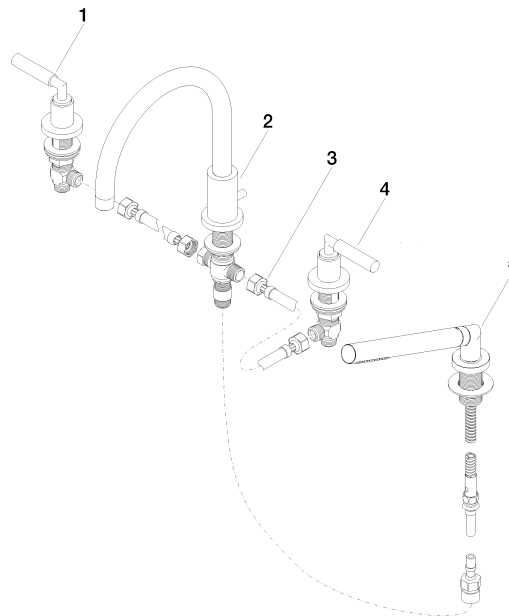

Spare parts list

No.	Item Number	Name	Quantity used	Delivery time
2	13 512 892-99	spout	1.00	60
1	20 000 882-99	TARA Deck valve clockwise closing - Brushed Dark Platinum	1.00	-
Spare part can no longer be ordered, please order the replacement item				
3	12 502 970 90	High pressure hose 1/2" x 1/2" x 400 mm -	2.00	2
4	20 000 883-99	TARA Deck valve anti-clockwise closing - Brushed Dark Platinum	1.00	-
Spare part can no longer be ordered, please order the replacement item				
5	27 702 979-99	Hand shower set for bath rim or tile edge installation - Brushed Dark Platinum	1.00	20