

Hand shower set with integrated shower holder FlowReduce - Brushed Dark Brass
SERIES SPECIFIC

27 803 660 Product version from 10/1/2023



- COMPACT RAIN, max. flow rate 6.8 l/min (at 3 bar)
- three settings: normal flow, soft flow, massage flow
- with anti-scale system
- 3/8" shower outlet
- metal shower hose 1250mm with integrated anti-twist protection
- rosette Ø 60 mm
- 1/2" connection
- Function from: 6 l/min
- This product reduces water consumption by 28% (compared to requirements of EPAct '92)
- This product can contribute to Water Use Reduction in LEED® Green Building Rating
- This product can help a building meet the requirements of Green Building Rating Systems, e.g. LEED®, BREEAM®, DGNB

Intrinsic protection against back flow.

	Brushed Dark Brass	27 803 660-39 0010
	Chrome	27 803 660-00 0010
	Brushed Platinum	27 803 660-06 0010
	Platinum	27 803 660-08 0010
	Dark Chrome	27 803 660-19 0010
	Light Gold	27 803 660-26 0010
	Brushed Light Gold	27 803 660-27 0010
	Brushed Durabrass (23kt Gold)	27 803 660-28 0010
	Matte Black	27 803 660-33 0010
	Brushed Bronze	27 803 660-42 0010
	Brushed Champagne (22kt Gold)	27 803 660-46 0010
	Champagne (22kt Gold)	27 803 660-47 0010
	Brushed Chrome	27 803 660-93 0010
	Brushed Dark Platinum	27 803 660-99 0010



Hand shower set with integrated shower holder FlowReduce - Brushed Dark Brass

SERIES SPECIFIC

27 803 660 Product version from 10/1/2023

mm [inches]

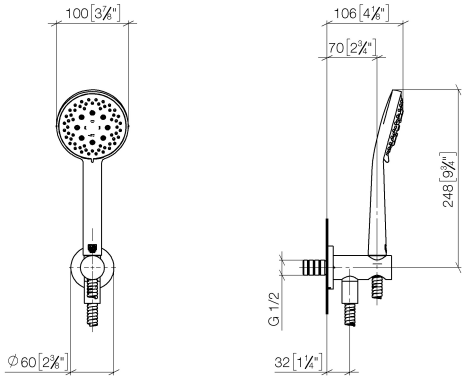

Codes & Standards			
California Energy Commission (CEC)	DIN 4109	ISO 3822	Ü-Zeichen

Certificates and sustainability

LGA_29

Hand shower set with integrated shower holder FlowReduce - Brushed Dark Brass

SERIES SPECIFIC

27 803 660 Product version from 10/1/2023

Parts for other
finishes can be found
here: [Chrome](#)

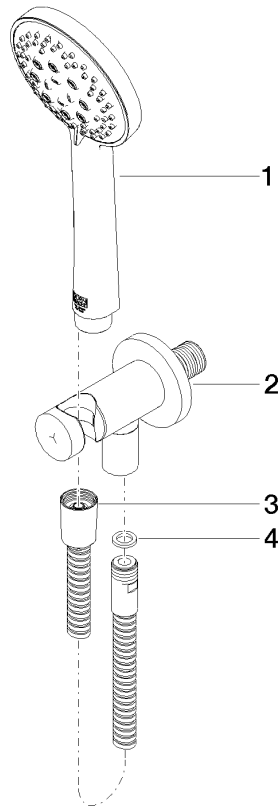

Spare parts list

No.	Item Number	Name	Quantity used	Delivery time
2	28 490 660-39	Wall elbow with integrated shower holder - Brushed Dark Brass	1.00	30
3	90 30 02 072 00-39	hose	1.00	30
1	28 014 979-39 0010	shower	1.00	-
Spare part can no longer be ordered, please order the replacement item				
4	90 14 20 026 00 90	seal	1.00	2