

## Rain shower for surface-mounted ceiling installation with light 300 x 240 mm - SERIES SPECIFIC Dark Chrome

28 042 980 Product version from 5/1/2022



- rain shower 300 x 240mm
- PURE RAIN, max. flow rate 6.8 l/min (at 3 bar)
- PURIFY RAIN, max. flow rate 6 l/min (at 3 bar)
- Distance to ceiling from bottom edge of shower 40 mm
- with anti-scale system

### Ceiling module power supply

- 350mA (CC)

### Spot lighting

- LED colour temperature approx. 3000 K
- Bulbs protected against splashing water
- Contains energy efficiency class bulbs
- Technology: LED, not dimmable
- Provided by customer: Light switch

### Environment

- Not suitable for outdoor use.
- Not suitable for use in a steam room.
- Not suitable for use in chlorinated or salty environments.
- Comply with the protection zone regulations as defined in DIN VDE 0100, Part 701 (IEC 60364-7-701).

**To meet the North American plumbing standards, this application must be installed with three-way diverter (rough included).**

To meet the North American plumbing standards, this application must be installed with three-way diverter (rough included).

	Dark Chrome	28 042 980-19 0010
	Chrome	28 042 980-00 0010
	Brushed Platinum	28 042 980-06 0010
	Platinum	28 042 980-08 0010
	Brushed Light Gold	28 042 980-27 0010
	Brushed Durabronze (23kt Gold)	28 042 980-28 0010
	Matte Black	28 042 980-33 0010
	Brushed Champagne (22kt Gold)	28 042 980-46 0010
	Champagne (22kt Gold)	28 042 980-47 0010
	Brushed Chrome	28 042 980-93 0010
	Brushed Dark Platinum	28 042 980-99 0010

## Required miscellaneous



**Concealed ceiling installation box for surface-mounted ceiling installation with light -** 35 042 970-90 0010

- min. recess depth 90 mm
- Pre-assembly kit for three-way diverter included
- max. recess depth 115 mm
- Provided by customer: Light switch

**Rain shower for surface-mounted ceiling installation with light 300 x 240 mm - SERIES SPECIFIC**  
**Dark Chrome**

28 042 980 Product version from 5/1/2022  
 mm [inches]

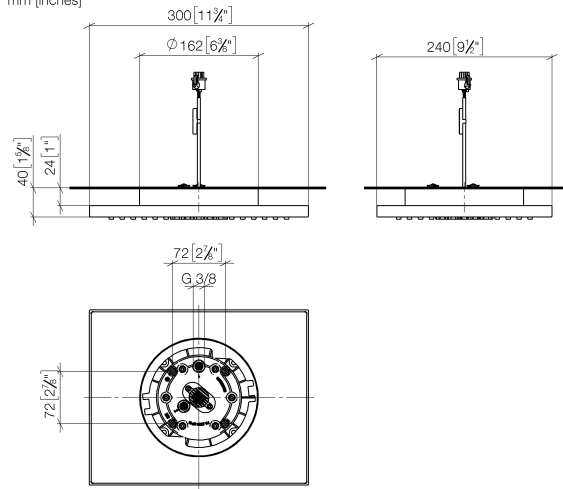

**Codes & Standards**

ASME A112.18.1	California Energy Commission (CEC)	cUPC
----------------	--	------

**Certificates and sustainability**

IAPMO\_4976

## Rain shower for surface-mounted ceiling installation with light 300 x 240 mm - SERIES SPECIFIC Dark Chrome

28 042 980 Product version from 5/1/2022

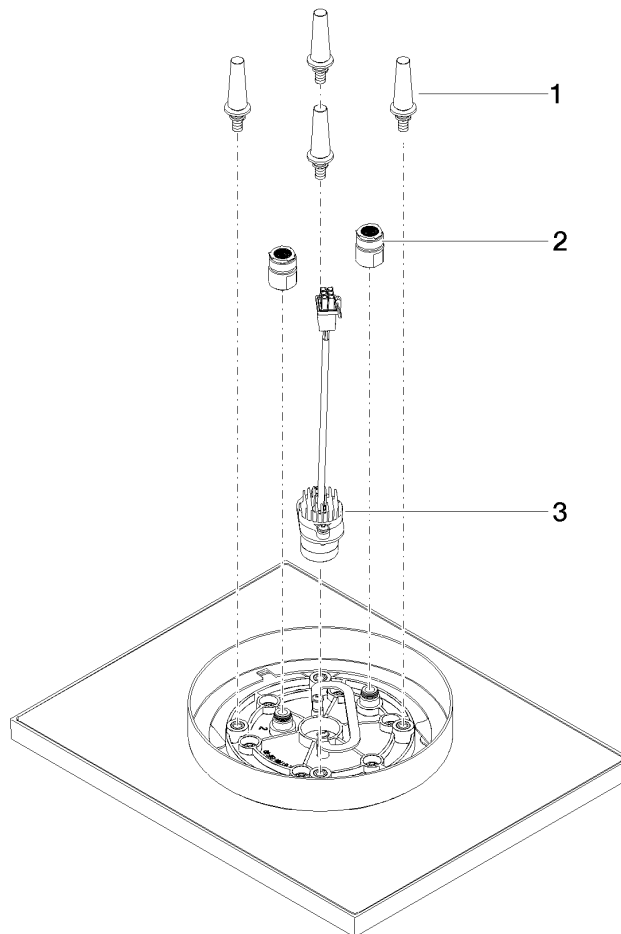

### Spare parts list

No.	Item Number	Name	Quantity used	Delivery time
3	90 10 01 225 00 90	electronic accessories	1.00	2
1	90 17 20 263 00 90	fixing set	1.00	2
2	90 24 03 309 02 90	connection	2.00	2