

28 450 809



- 3/8" shower outlet
- rosette Ø 60 mm
- 1/2" connection
- WRAS 1810006

Intrinsic protection against back flow.

| | | |
|---|-------------------------------------|---------------|
|  | Platinum | 28 450 809-08 |
|  | Chrome | 28 450 809-00 |
|  | Brushed Platinum | 28 450 809-06 |
|  | Dark Chrome | 28 450 809-19 |
|  | Brushed Durabronze (23kt Gold) | 28 450 809-28 |
|  | Brushed Bronze | 28 450 809-42 |
|  | Brushed Champagne (22kt Gold) | 28 450 809-46 |
|  | Champagne (22kt Gold) | 28 450 809-47 |
|  | Brushed Dark Platinum | 28 450 809-99 |

28 450 809

mm [inches]

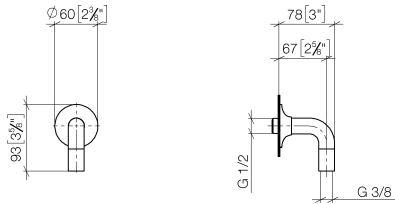

Flow rate chart



Codes & Standards

ASME
A112.18.1/CSA
B125.1



VAIA Wall elbow - Platinum

VAIA

28 450 809

Certificates

WRAS_1810006. Belgaqua_22_280_2 IAPMO_4976 (2).
7_7.

28 450 809

Parts for other finishes can be found here: [Chrome](#)

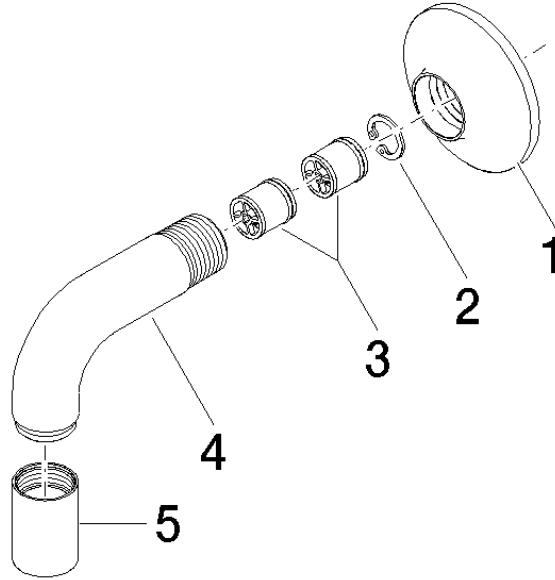

Spare parts list

| No. | Item Number | Name | Quantity used | Delivery time |
|-----|--------------------|---------------------|---------------|---------------|
| 1 | 90 27 80 021 00-08 | rosette | 1 | 40 |
| 2 | 09 16 01 014 90 | ring | 1 | 2 |
| 3 | 90 23 01 040 00 90 | back-flow preventer | 2 | 2 |
| 4 | 09 11 03 123-08 | connection | 1 | 40 |
| 5 | 90 21 02 069 00-08 | cover | 1 | 40 |