

# Shower head FlowReduce - Chrome

SERIES SPECIFIC

28 508 980 Product version up to 5/15/2020



- spray head Ø 92mm
- Three settings: COMPACT RAIN, COMPACT SOFT FLOW, COMPACT AQUAPRESSURE FLOW, max. flow rate 6.8 l/min (at 3 bar)
- Function from: l/min
- with anti-scale system

**Technical data:**

- 200mm projection
- ball-joint pivotable through 30°
- rosette 60 x 60 mm
- 1/2" connection

	Chrome	28 508 980-00 0010
	Brushed Platinum	28 508 980-06 0010
	Platinum	28 508 980-08 0010
	Dark Chrome	28 508 980-19 0010
	Brushed Light Gold	28 508 980-27 0010
	Brushed Durabrass (23kt Gold)	28 508 980-28 0010
	Matte Black	28 508 980-33 0010
	Brushed Champagne (22kt Gold)	28 508 980-46 0010
	Champagne (22kt Gold)	28 508 980-47 0010
	Brushed Chrome	28 508 980-93 0010
	Brushed Dark Platinum	28 508 980-99 0010



Codes & Standards			
ASME A112.18.1	California Energy Commission (CEC)	cUPC	DIN 4109
EPA WaterSense	ISO 3822	Ü-Zeichen	WaterSense



Certificates and sustainability		
LGA_38	IAPMO_4976	IAPMO_11777

28 508 980    Product version up to 5/15/2020

Parts for other  
finishes can be found  
here: [Brushed  
Platinum](#)

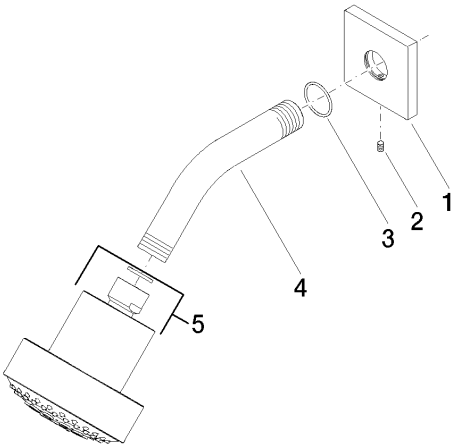

Spare parts list

No.	Item Number	Name	Quantity used	Delivery time
3	09 14 10 098 90	seal	1.00	2
4	09 11 03 011-00	connection	1.00	10
2	09 31 11 048 90	pin	1.00	2
1	09 27 98 003-00	rosette	1.00	10
5	04 12 11 110 30-00	shower	1.00	10