

## MADISON Rain shower with wall fixing 200 mm - Chrome

MADISON

28 545 977 Product version up to 12/5/2019



- rain shower Ø 200 mm
- Rain shower: PURE RAIN, max. flow rate 6.8 l/min (at 3 bar)
- with anti-scale system

### Technical dimensions:

- 435mm projection
- rosette Ø 55 mm
- 1/2" connection

### Notes:

- This product reduces water consumption by 28% (compared to requirements of EPAct '92)
- This product can help a building meet the requirements of Green Building Rating Systems, e.g. LEED®, BREEAM®, DGNB

	Chrome	28 545 977-00 0010
	Brushed Platinum	28 545 977-06 0010
	Platinum	28 545 977-08 0010
	Durabrand (23kt Gold)	28 545 977-09 0010
	Brushed Durabrand (23kt Gold)	28 545 977-28 0010
	Brushed Dark Platinum	28 545 977-99 0010

## Required miscellaneous



- Concealed wall elbow -** 35 085 970-90  
 •max. recess depth 163 mm 0010  
 •min. recess depth 90 mm

**MADISON Rain shower with wall fixing 200 mm - Chrome**

MADISON

28 545 977 Product version up to 12/5/2019

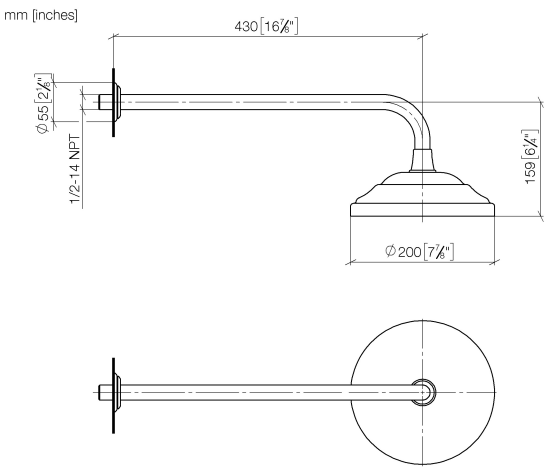

**Codes & Standards**

ASME A112.18.1      California Energy Commission (CEC)      cUPC      EPA WaterSense

WaterSense



**Certificates and sustainability**

IAPMO\_4976      IAPMO\_11777

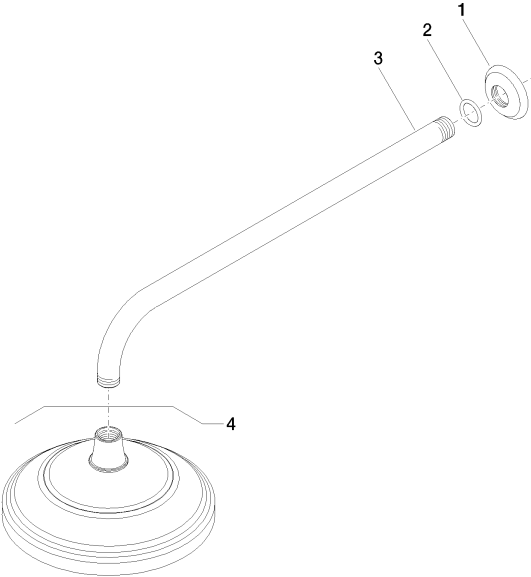

Spare parts list

No.	Item Number	Name	Quantity used	Delivery time
4	28 535 977-00 0010	shower	1.00	60
3	09 11 03 017-00	connection	1.00	10
1	09 27 35 003-00	rosette	1.00	10
2	90 14 10 026 00 90	seal	1.00	2