

Rain shower with ceiling fixing 300 mm - Dark Chrome

SERIES SPECIFIC

28 689 970



- PURE RAIN, max. flow rate 6.8 l/min (at 3 bar)
- with anti-scale system
- rain shower Ø 300 mm
- rosette Ø 60 mm optional
- 1/2" connection
- Function from: 6.5 l/min
- quick clearing
- This product reduces water consumption by 28% (compared to requirements of EPAct '92)
- This product can contribute to Water Use Reduction in LEED® Green Building Rating
- This product can help a building meet the requirements of Green Building Rating Systems, e.g. LEED®, BREEAM®, DGNB

| | | |
|---|-------------------------------|--------------------|
|  | Dark Chrome | 28 689 970-19 0010 |
|  | Chrome | 28 689 970-00 0010 |
|  | Brushed Platinum | 28 689 970-06 0010 |
|  | Platinum | 28 689 970-08 0010 |
|  | Light Gold | 28 689 970-26 0010 |
|  | Brushed Light Gold | 28 689 970-27 0010 |
|  | Brushed Durabrass (23kt Gold) | 28 689 970-28 0010 |
|  | Matte Black | 28 689 970-33 0010 |
|  | Brushed Bronze | 28 689 970-42 0010 |
|  | Brushed Champagne (22kt Gold) | 28 689 970-46 0010 |
|  | Champagne (22kt Gold) | 28 689 970-47 0010 |
|  | Brushed Chrome | 28 689 970-93 0010 |
|  | Brushed Dark Platinum | 28 689 970-99 0010 |

Required miscellaneous



- Concealed wall elbow -** 35 085 970-90
- max. recess depth 163 mm 0010
 - min. recess depth 90 mm

28 689 970

mm [inches]

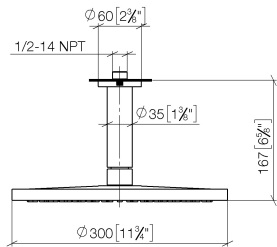

Codes & Standards

| | | |
|----------------|--|------|
| ASME A112.18.1 | California Energy Commission (CEC) | cUPC |
|----------------|--|------|

Certificates and sustainability

IAPMO_4976

28 689 970

