









META Wall-mounted valve cold water without pop-up waste - Brushed Bronze

META

30 010 662
Product version from 5/1/2022

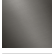

- 126mm projection
- fixed spout
- circular, air-enriched flow
- hole diameter 35 mm
- rosette Ø 60 mm
- max. flow 4.5 l/min
- lead-free
- This product can help a building meet the requirements of Green Building Rating Systems, e.g. LEED®, BREEAM®, DGNB

	Brushed Bronze	30 010 662-42 0010
	Chrome	30 010 662-00 0010
	Brushed Platinum	30 010 662-06 0010
	Light Gold	30 010 662-26 0010
	Brushed Light Gold	30 010 662-27 0010
	Matte Black	30 010 662-33 0010
	Brushed Champagne (22kt Gold)	30 010 662-46 0010
	Champagne (22kt Gold)	30 010 662-47 0010
	Brushed Chrome	30 010 662-93 0010
	Brushed Dark Platinum	30 010 662-99 0010

Recommended miscellaneous



- Concealed wall elbow -**
 - min. recess depth 90 mm
 - max. recess depth 163 mm

35 085 970-90
0010

mm [inches]

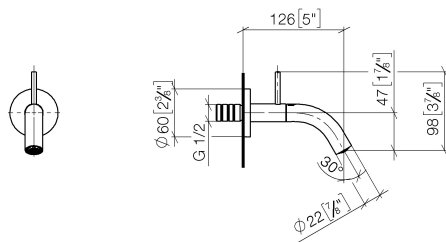

Codes & Standards

ADA	ASME A112.18.1	California Energy Commission (CEC)	cUPC
NSF372	NSF61		

Certificates and sustainability

IAPMO_N-4	IAPMO_6	IAPMO_4976 (
-----------	---------	--------------

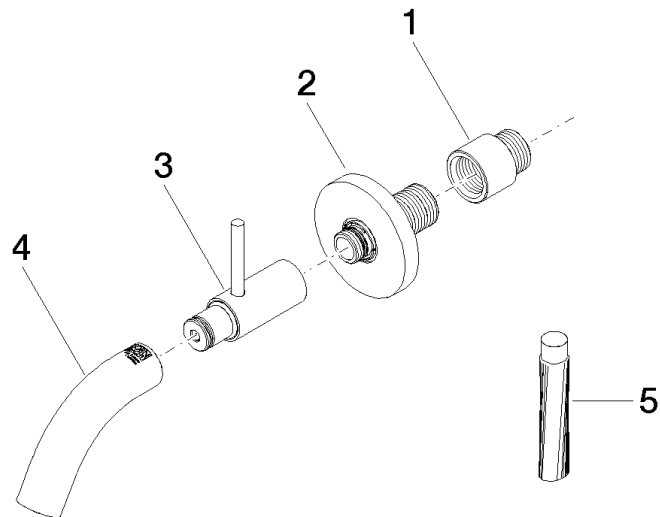

Spare parts list

No.	Item Number	Name	Quantity used	Delivery time
2	90 27 66 019 00-42	rosette	1.00	30
1	09 24 03 072 10 90	nipple	1.00	2
3	90 20 66 023 00-42	handle	1.00	30
5	09 16 03 001 90	grease	1.00	2
4	90 28 22 386 00-42	spout	1.00	30