

## VAIA Wall-mounted valve cold water without pop-up waste - Brushed Dark Brass

VAIA

30 010 809 Product version from 4/1/2025



- 151mm projection
- fixed spout
- circular, air-enriched flow
- adapter with male thread 3/4"
- hole diameter 35 mm
- rosette Ø 60 mm
- max. flow 4.5 l/min
- lead-free
- This product can help a building meet the requirements of Green Building Rating Systems, e.g. LEED®, BREEAM®, DGNB

	Brushed Dark Brass	30 010 809-39 0010
	Chrome	30 010 809-00 0010
	Brushed Platinum	30 010 809-06 0010
	Platinum	30 010 809-08 0010
	Dark Chrome	30 010 809-19 0010
	Brushed Durabronze (23kt Gold)	30 010 809-28 0010
	Brushed Bronze	30 010 809-42 0010
	Brushed Champagne (22kt Gold)	30 010 809-46 0010
	Champagne (22kt Gold)	30 010 809-47 0010
	Brushed Dark Platinum	30 010 809-99 0010

VAIA Wall-mounted valve cold water without pop-up waste - Brushed Dark Brass

VAIA

30 010 809

Product version from 4/1/2025

mm [inches]

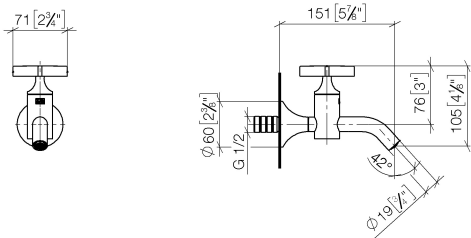

Codes & Standards

ADA	California Energy Commission (CEC)	NSF372	NSF61
-----	------------------------------------	--------	-------

Certificates and sustainability

IAPMO_6397	IAPMO_N-4976
------------	--------------

## VAIA Wall-mounted valve cold water without pop-up waste - Brushed Dark Brass

VAIA

30 010 809 Product version from 4/1/2025

Parts for other  
finishes can be found  
here: [Chrome](#)

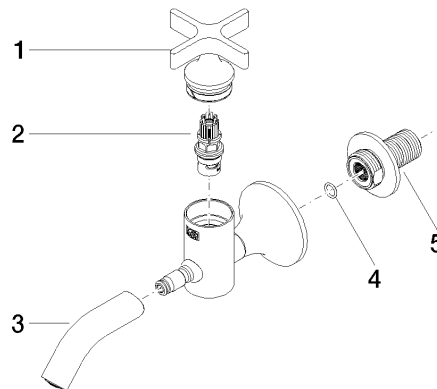

### Spare parts list

No.	Item Number	Name	Quantity used	Delivery time
	4 90 14 10 060 00 90	seal	1.00	2
	3 90 28 22 381 01-39	spout	1.00	30
	2 90 90 03 175 00 90	top	1.00	2
	5 09 24 03 269 90	nipple	1.00	2
	1 90 20 66 025 00-39	handle	1.00	30