

LOT Single-lever mixer - Brushed Bronze

LOT

33 800 680
Product version from 3/1/2023

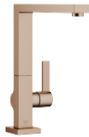

- 236mm projection
  - pivotable spout 360°
  - air-enriched flow
  - height of mixer 292 mm
  - height up to aerator 267 mm
  - hole diameter 35 mm
  - 2 x pressure hose with 3/8" cap nut
  - max. flow 5.7 l/min at 3 bar flow pressure
  - lead-free
  - This product can help a building meet the requirements of Green Building Rating Systems, e.g. LEED®, BREEAM®, DGNB
- Not possible in combination with rinsing spray.

	Brushed Bronze	33 800 680-42 0010
	Chrome	33 800 680-00 0010
	Brushed Platinum	33 800 680-06 0010
	Platinum	33 800 680-08 0010
	Dark Chrome	33 800 680-19 0010
	Brushed Durabrass (23kt Gold)	33 800 680-28 0010
	Brushed Champagne (22kt Gold)	33 800 680-46 0010
	Champagne (22kt Gold)	33 800 680-47 0010
	Brushed Dark Platinum	33 800 680-99 0010

Recommended miscellaneous

	<b>Dispenser with rosette - Brushed Bronze</b>	82 439 970-42
---	--	---------------

Recommended miscellaneous

	<b>AIR SWITCH Control button - Brushed Bronze</b>	10 714 970-42
---	---	---------------

**LOT Single-lever mixer - Brushed Bronze**

LOT

33 800 680 Product version from 3/1/2023

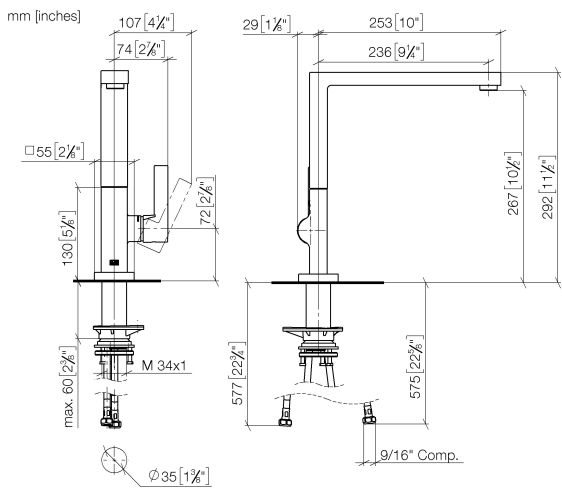

**Codes & Standards**

ADA	ASME A112.18.1	California Energy Commission (CEC)	cUPC
NSF372	NSF61		

**Certificates and sustainability**

IAPMO\_6397 IAPMO\_N-4976 IAPMO\_4976 (

## LOT Single-lever mixer - Brushed Bronze

LOT

33 800 680 Product version from 3/1/2023

Parts for other  
finishes can be found  
here: [Chrome](#)

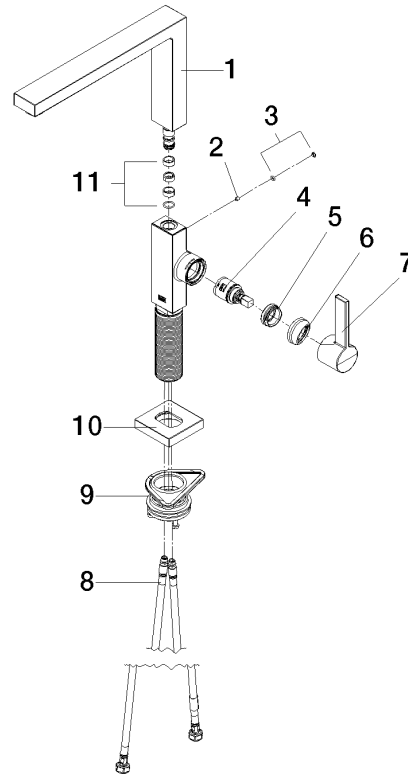

### Spare parts list

No.	Item Number	Name	Quantity used	Delivery time
8	04 30 04 103 00 90	hose	2.00	2
7	90 20 86 004 00-42	handle	1.00	20
1	90 11 06 218 01-42	spout	1.00	20
11	90 28 10 207 00 90	gasket kit	1.00	2
2	09 31 11 044 90	pin	1.00	2
4	90 15 05 042 00 90	cartridge	1.00	2
6	90 28 30 052 00-42	cover	1.00	20
3	90 31 20 087 00-42	plug	1.00	20
5	09 24 04 266 90	nut	1.00	2
10	90 27 86 004 00-42	rosette	1.00	20
9	90 30 10 057 00 90	fixing set	1.00	2