

Showerpipe with shower thermostat without hand shower - Matte Black

SERIES SPECIFIC

34 459 979 Product version from 7/1/2023



- shower with fixed riser projection 453mm
- overhead shower: rain flow
- rain shower with anti-scale system
- rain shower Ø 220 mm
- max. rainshower flow 6.8 l/min
- rotary diverter with volume control and shut-off function
- height of fittings up to top edge of elbow 1150mm
- slide-on rosettes Ø 70 mm
- height of fittings up to rain shower (bottom edge) 1009mm
- gauge 150 mm - 13 mm
- metal shower hose 1750mm with integrated anti-twist protection
- 1/2" connection
- slide bar
- Pipe diameter 23.5 mm
- quick clearing
- This product reduces water consumption by 28% (compared to requirements of EPAct '92)
- This product can contribute to Water Use Reduction in LEED® Green Building Rating

Intrinsic protection against back flow.

NOTE: Hand shower sold separately. Please see hand shower options under the miscellaneous articles section of each series.

	Matte Black	34 459 979-33 0010
	Chrome	34 459 979-00 0010
	Brushed Platinum	34 459 979-06 0010
	Platinum	34 459 979-08 0010
	Dark Chrome	34 459 979-19 0010
	Light Gold	34 459 979-26 0010
	Brushed Light Gold	34 459 979-27 0010
	Brushed Durabronze (23kt Gold)	34 459 979-28 0010
	Brushed Bronze	34 459 979-42 0010
	Brushed Champagne (22kt Gold)	34 459 979-46 0010
	Champagne (22kt Gold)	34 459 979-47 0010
	Brushed Chrome	34 459 979-93 0010
	Brushed Dark Platinum	34 459 979-99 0010

Required miscellaneous



Hand shower FlowReduce - Matte Black 28 012 979-33 0010

Required miscellaneous



Hand shower FlowReduce - Matte Black 28 018 979-33 0010

Required miscellaneous



SERIES-VARIOUS Hand shower FlowReduce - Matte Black 28 025 979-33 0010

Required miscellaneous



Hand shower FlowReduce - Matte Black 28 016 979-33 0010

Required miscellaneous



SERIES-VARIOUS Hand shower FlowReduce - Matte Black 28 027 979-33 0010

Required miscellaneous



SERIES-VARIOUS Hand shower FlowReduce - Matte Black 28 029 979-33 0010

34 459 979 Product version from 7/1/2023

Parts for other
finishes can be found
here: [Chrome](#)

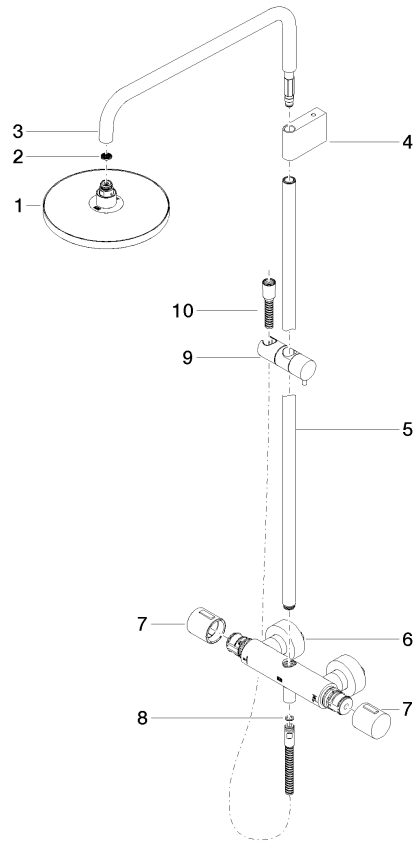

Spare parts list

No.	Item Number	Name	Quantity used	Delivery time
	10 28 322 970-33	Metal shower hose 1/2" x 3/8" x 1750 mm - Matte Black	1.00	2
	6 04 17 01 250 00-33	connection	1.00	30
	7 90 17 33 015 00-33	handle	2.00	30
	5 90 28 22 349 00-33	pipe	1.00	30
	4 90 17 11 150 00-33	holder	1.00	30
	3 90 28 22 348 00-33	pipe	1.00	30
	2 09 23 01 039 90	sieve	1.00	2
	9 12 570 970-33	Slide unit - Matte Black	1.00	30
	1 04 12 05 092 10-33	shower	1.00	30
	8 90 14 20 026 00 90	seal	1.00	2