

Showerpipe with shower thermostat without hand shower - Platinum

SERIES SPECIFIC

34 459 980 Product version from 6/1/2024



- shower with fixed riser projection 453mm
 - overhead shower: rain flow
 - rain shower 300 x 240mm
 - rain shower with anti-scale system
 - max. rainshower flow 6.8 l/min
 - Function from: 6 l/min
 - rotary diverter with volume control and shut-off function
 - slide-on rosettes Ø 70 mm
 - height of fittings up to rain shower (bottom edge) 1009mm
 - height of fittings up to top edge of elbow 1150mm
 - gauge 150 mm - 13 mm
 - metal shower hose 1750mm with integrated anti-twist protection
 - 1/2" connection
 - slide bar
 - Pipe diameter 23.5 mm
 - quick clearing
 - This product reduces water consumption by 28% (compared to requirements of EPAct '92)
 - This product can contribute to Water Use Reduction in LEED® Green Building Rating
- Intrinsic protection against back flow.**

NOTE: Hand shower sold separately. Please see hand shower options under the miscellaneous articles section of each series.

Intrinsic protection against back flow.

NOTE: Hand shower sold separately. Please see hand shower options under the miscellaneous articles section of each series.

	Platinum	34 459 980-08 0010
	Chrome	34 459 980-00 0010
	Brushed Platinum	34 459 980-06 0010
	Dark Chrome	34 459 980-19 0010
	Brushed Light Gold	34 459 980-27 0010
	Brushed Durabrass (23kt Gold)	34 459 980-28 0010
	Matte Black	34 459 980-33 0010
	Brushed Champagne (22kt Gold)	34 459 980-46 0010
	Champagne (22kt Gold)	34 459 980-47 0010
	Brushed Chrome	34 459 980-93 0010
	Brushed Dark Platinum	34 459 980-99 0010

Required miscellaneous



Concealed adapter -

- please order two adapters (USA only)

35 080 970-90
0010

Required miscellaneous



Hand shower FlowReduce - Platinum

28 016 979-08
0010

Required miscellaneous



SERIES-VARIOUS Hand shower FlowReduce - Platinum

28 027 979-08
0010

Required miscellaneous



SERIES-VARIOUS Hand shower FlowReduce - Platinum

28 025 979-08
0010

Required miscellaneous



Hand shower FlowReduce - Platinum

28 012 979-08
0010

Required miscellaneous



Hand shower FlowReduce - Platinum

28 018 979-08
0010

Required miscellaneous



SERIES-VARIOUS Hand shower FlowReduce - Platinum

28 029 979-08
0010

34 459 980 Product version from 6/1/2024

mm [inches]
1:10

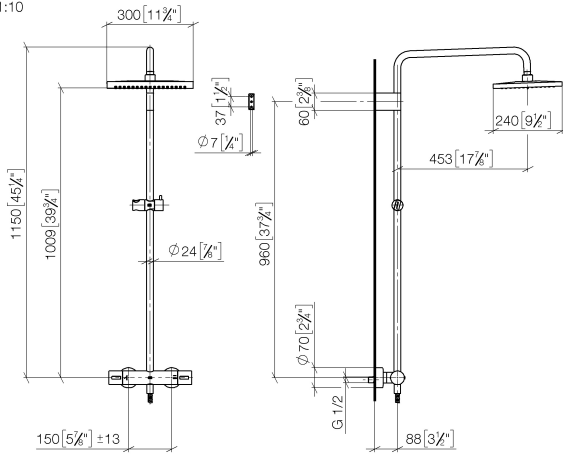

Codes & Standards

California Energy
Commission
(CEC)

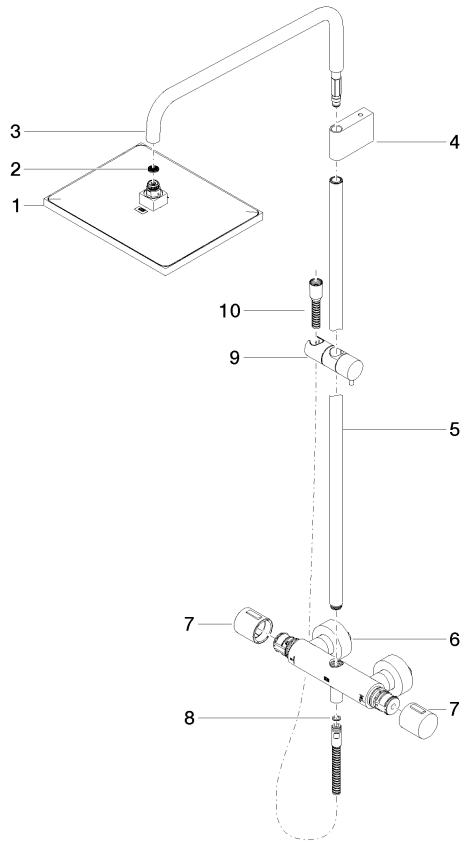

Spare parts list

No.	Item Number	Name	Quantity used	Delivery time
9	12 570 970-08	Slide unit - Platinum	1.00	40
7	90 17 33 015 00-08	handle	1.00	40
4	90 17 11 150 00-08	holder	1.00	40
2	09 23 01 039 90	sieve	1.00	2
5	90 28 22 349 00-08	pipe	1.00	40
6	04 17 01 250 00-08	connection	1.00	40
10	28 322 970-08	Metal shower hose 1/2" x 3/8" x 1750 mm - Platinum	1.00	40
3	90 28 22 348 00-08	pipe	1.00	40
1	04 12 05 063 10-08	shower	1.00	40
8	90 14 20 026 00 90	seal	1.00	2