

Concealed thermostat with three function volume control - Brushed Champagne (22kt Gold)

SERIES SPECIFIC

36 428 670

Product version from 6/30/2022



- rotary diverter with volume control and shut-off function
- cover plate 150 x 90 mm
- temperature control handle with safety limit stop at 38°C
- hot water temperature limiter, can be preset
- single flow function only

	Brushed Champagne (22kt Gold)	36 428 670-46 0010
	Chrome	36 428 670-00 0010
	Brushed Platinum	36 428 670-06 0010
	Platinum	36 428 670-08 0010
	Dark Chrome	36 428 670-19 0010
	Brushed Light Gold	36 428 670-27 0010
	Brushed Durabrass (23kt Gold)	36 428 670-28 0010
	Matte Black	36 428 670-33 0010
	Champagne (22kt Gold)	36 428 670-47 0010
	Brushed Chrome	36 428 670-93 0010
	Brushed Dark Platinum	36 428 670-99 0010

Required miscellaneous

	Concealed thermostat for three-way outlets - •max. recess depth 136 mm •min. recess depth 80 mm	35 428 970-90 0010
---	--	--------------------

Required miscellaneous

	xGRID Installation track 555 mm -	12 360 970 90
---	--	---------------

Recommended miscellaneous

	xGRID Attachment set for integrating in the dry wall construction -	12 340 970 90
---	--	---------------



Concealed thermostat with three function volume control - Brushed Champagne SERIES SPECIFIC (22kt Gold)

36 428 670 Product version from 6/30/2022
mm [inches]

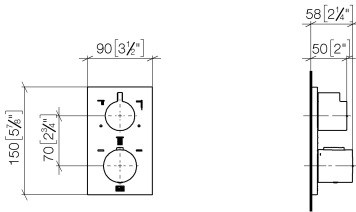

Codes & Standards

ADA	ASME A112.18.1	California Energy Commission (CEC)	cUPC
-----	----------------	------------------------------------	------

Certificates and sustainability

IAPMO_4976 (

Concealed thermostat with three function volume control - Brushed Champagne SERIES SPECIFIC (22kt Gold)

36 428 670 Product version from 6/30/2022

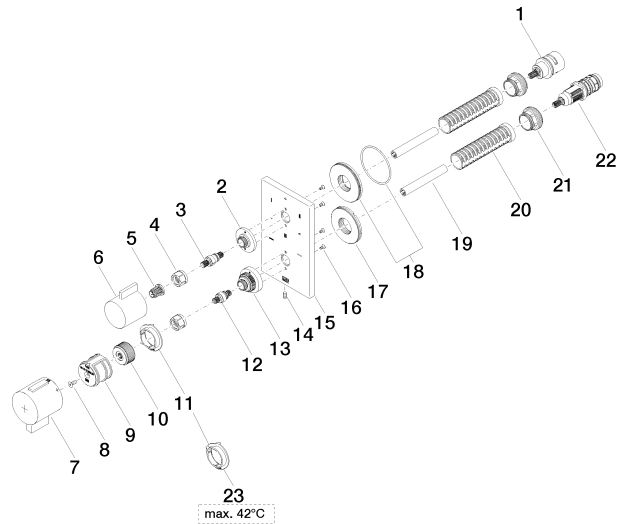



Concealed thermostat with three function volume control - Brushed Champagne (22kt Gold) SERIES SPECIFIC

36 428 670 Product version from 6/30/2022

Spare parts list

No.	Item Number	Name	Quantity used	Delivery time
15	09 11 02 323-46	plate	1.00	30
6	09 20 67 006-46	handle	1.00	30
5	90 12 12 002 00 90	fixing cap	1.00	2
17	09 30 01 296 90	disc	1.00	2
11	09 28 10 190 90	regulator	1.00	2
14	09 31 11 134 90	pin	1.00	2
7	90 17 33 019 00-46	handle	1.00	30
21	09 24 04 257 90	nut	2.00	2
23	09 28 10 189 90	regulator	1.00	2
1	90 90 03 170 00 90	diverter	1.00	2
16	09 30 30 157 90	screw	4.00	2
18	90 30 01 190 00 90	disc	1.00	2
22	90 15 02 013 00 90	cartridge	1.00	2
10	09 12 12 054 90	base	1.00	2
13	09 12 12 051-46	base	1.00	60
2	09 12 12 053-46	base	1.00	60
8	90 30 30 124 00 90	screw	1.00	2
3	04 29 06 111 01-00	spindle	1.00	10
9	90 12 12 052 00 90	base	1.00	2
12	04 29 06 024 01-00	spindle	1.00	10
20	90 18 40 077 01 90	spindle	2.00	2
4	90 23 30 023 00 90	nut	2.00	2
19	90 23 01 124 00 90	sleeve	2.00	2